

# United Kingdom Price List July 2026

Prices effective from 1st July 2026

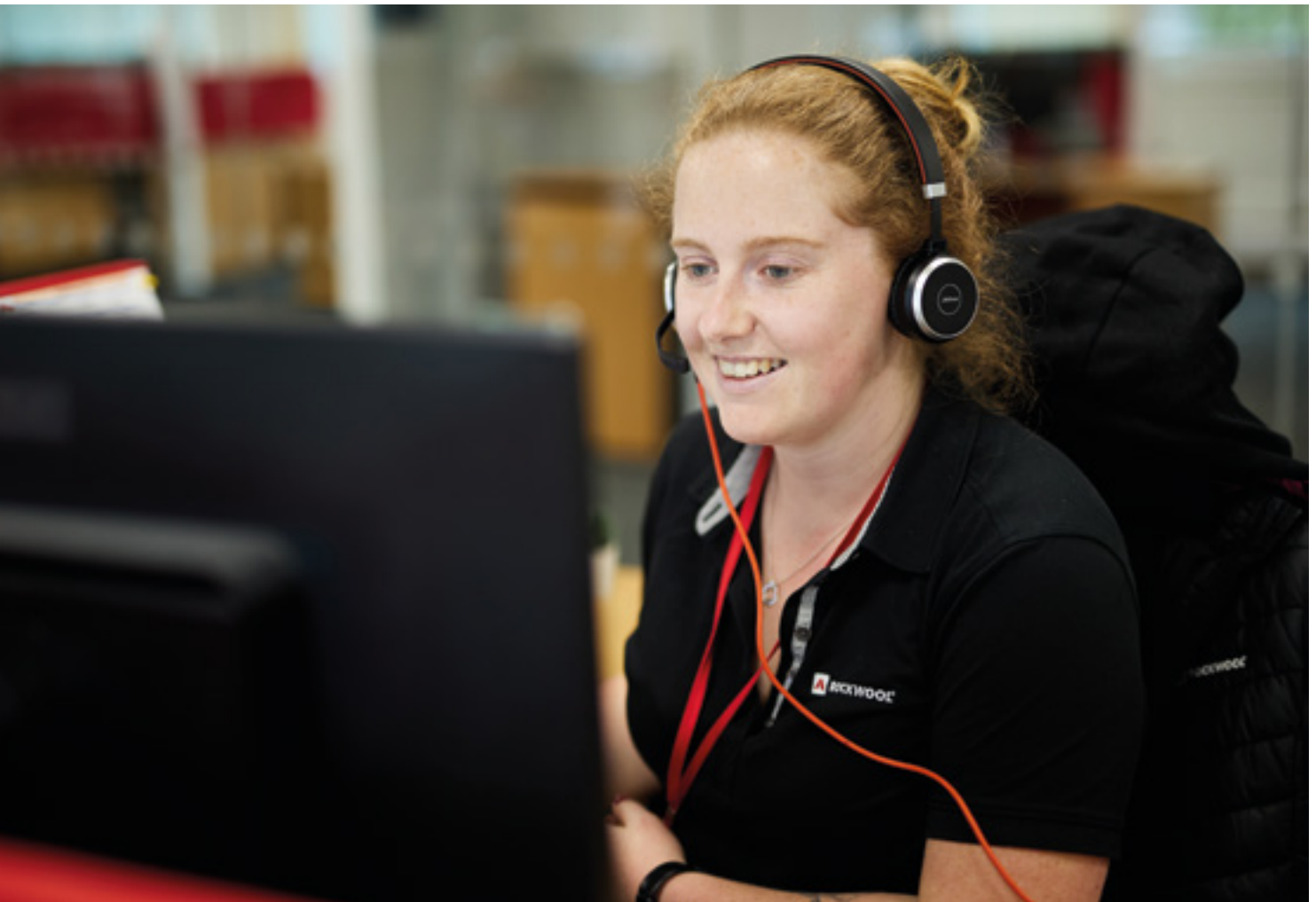

# Contact us



## Customer Support Centre

To place an order or for a price enquiry please contact:

Email: [customersupportcentre@rockwool.com](mailto:customersupportcentre@rockwool.com)  
Telephone: 01656 868 400

### Opening times

Monday	6.30am-6.00pm
Tuesday	6.30am-6.00pm
Wednesday	6.30am-6.00pm
Thursday	6.30am-6.00pm
Friday	6.30am-5.00pm

## Technical Solutions

For all technical product and application queries please contact:

Email: [technical.solutions@rockwool.com](mailto:technical.solutions@rockwool.com)  
Telephone: 01656 868 490

### Opening times

Monday	9am-5pm
Tuesday	9am-5pm
Wednesday	9am-5pm
Thursday	9am-5pm
Friday	9am-4pm

# Full load pallet quantities

To assist with load building, we have outlined below how many pallets comprise a full load for each of the available pallet sizes. Depending upon the pallet size and product, the number of pallets in a full load will vary, we have outlined below the details for these.

## Pallet size: 1200mm x 1200mm

FULL LOAD = 22 PALLETS

- Cladding Roll
- DuctSlab
- DuctWrap
- Fire Barrier EN
- Flexi®
- Full Fill Cavity Batt
- HardRock® Multi-Fix Angle Fillets
- High Performance Partial Fill Cavity Slab
- NyRock® Cavity Slab 032
- NyRock® Frame Slab 032
- RainScreen Duo Slab®
- Roll
- Rollbatt
- RWA45
- RW3
- Steel Frame Slab
- Timber Frame Slab
- Twin Roll

FULL LOAD = 40 PALLETS

- FirePro® CB50

FULL LOAD = 42 PALLETS

- FirePro® Ablative Coated Batt

## Pallet size: 1300mm x 1200mm

FULL LOAD = 40 PALLETS

- SCB (sizes marked with \* only)

## Pallet size: 2400mm x 1200mm

FULL LOAD = 22 PALLETS

- HardRock® UB34
- RW4 (Plain)
- RW5 (Plain)
- NyRock® Rainscreen 032

FULL LOAD = 20 PALLETS

- High Impact Soffit Slab

## Pallet size: 1200mm x 1000mm

FULL LOAD = 52 PALLETS

- Acoustic Infills
- HardRock® Multi-Fix (DD)
- HardRock® Multi-Fix Recovery Board
- RockFloor®
- RockLap H&V Pipe Section

## Pallet size: 2000mm x 1200mm

FULL LOAD = 26 PALLETS

- Fire Duct Slab (Foil Faced)
- DuctRock® Slab
- SP FireStop EN
- BeamClad®
- RW4 (Foil/Tissue Faced)
- RW5 (Foil/Tissue Faced)
- RW6 (Foil/Tissue Faced)
- Soffit Slab

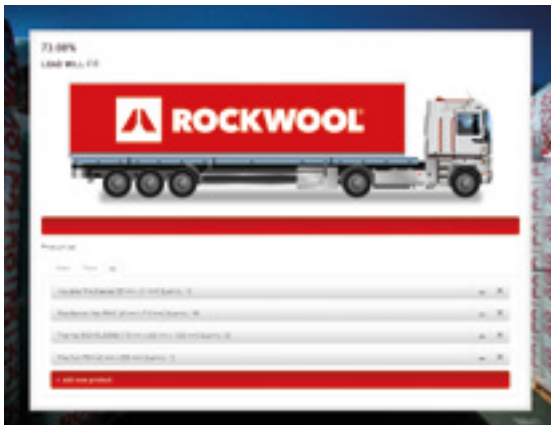

## Indicative Load Calculator

The Load Calculator forms part of the ROCKWOOL full service offering to make product selection and transportation quicker and easier, providing support to build your loads, ensuring all requirements are able to fit on the vehicle.

Try it for yourself at:

[rockwool.com/uk/loadcalc](https://rockwool.com/uk/loadcalc)

# Helping you meet demand



We are continuing to invest in logistics at ROCKWOOL to ensure that you receive the best possible service – that means getting you what you need, when you need it.

Some of our latest improvements include:

- The ROCKWOOL National Logistics Centre, a dedicated and expert hub for our inward and outbound logistics including a 60,000m<sup>2</sup> hard stand to help mobilise stock faster.
- An upgraded fleet, including branded artic and rigid vehicles for local and specialist deliveries.
- Continual improvements behind the scenes to ensure your products are picked, packaged, and shipped in a timely and effective manner.

# Contents

	Page No.
Terms and conditions	<a href="#">6</a>
Delivery	<a href="#">7</a>
The Euroclass system	<a href="#">10</a>

## THINK YOU KNOW NYROCK?

NyRock® Cavity Slab 032	<a href="#">14</a>
NyRock® Frame Slab 032	<a href="#">17</a>
NyRock® Rainscreen 032	<a href="#">20</a>

## BUILDING INSULATION

<b>CAVITY SOLUTIONS</b>	<a href="#">14</a>
NyRock® Cavity Slab 032	<a href="#">14</a>
RockClose® EN	<a href="#">15</a>
Full Fill Cavity Batt	<a href="#">15</a>
<b>FRAME SOLUTIONS</b>	<a href="#">16</a>
NyRock® Frame Slab 032	<a href="#">17</a>
Timber Frame Slab	<a href="#">17</a>
Steel Frame Slab	<a href="#">17</a>
<b>CLADDING SOLUTIONS</b>	<a href="#">18</a>
RainScreen Duo Slab®	<a href="#">19</a>
NyRock® Rainscreen 032	<a href="#">20</a>
Cladding Roll	<a href="#">20</a>
SP FireStop OSCB 25	<a href="#">22</a>
SP FireStop OSCB 44	<a href="#">23</a>
SP FireStop EN	<a href="#">23</a>
<b>FLAT ROOF SOLUTIONS</b>	<a href="#">25</a>
HardRock® UB34	<a href="#">26</a>
HardRock® Multi-Fix (DD)	<a href="#">26</a>
HardRock® Multi-Fix (DD) Underlay Slab	<a href="#">27</a>
HardRock® Multi-Fix Recovery Board	<a href="#">27</a>
HardRock® Multi-Fix Angle Fillets	<a href="#">27</a>
Acoustic Infills	<a href="#">28</a>
<b>FLOOR SOLUTIONS</b>	<a href="#">30</a>
Acoustic RockFloor®	<a href="#">31</a>
Thermal RockFloor®	<a href="#">31</a>
<b>ROLL PRODUCTS</b>	<a href="#">32</a>
Twin Roll	<a href="#">33</a>
Roll	<a href="#">33</a>
Rollbatt	<a href="#">33</a>
<b>SLAB PRODUCTS</b>	<a href="#">34</a>
Flexi®	<a href="#">35</a>
RW Slab Range RWA45	<a href="#">35</a>
RW Slab Range RW3, RW4, RW5	<a href="#">36</a>

## TECHNICAL INSULATION

<b>STRUCTURAL AND CAVITY FIRE PROTECTION PRODUCTS</b>	<a href="#">38</a>
BeamClad®	<a href="#">39</a>
FirePro® Glue	<a href="#">39</a>
Fire Barrier EN	<a href="#">40</a>
SP FireStop EN	<a href="#">40</a>
SP FireStop Fixing Brackets	<a href="#">41</a>
Dovetail Infills	<a href="#">41</a>
Linear FireStop 2A	<a href="#">42</a>
Trapezoidal FireStop 2B	<a href="#">43</a>
SCB (Sleeved Cavity Barrier)	<a href="#">44</a>
Soffit Slab	<a href="#">46</a>
High Impact Soffit Slab	<a href="#">46</a>
<b>FIRE-STOPPING SOLUTIONS</b>	<a href="#">47</a>
<b>NEW RANGE</b>	
FirePro® CB50	<a href="#">48</a>
FirePro® CB Coating	<a href="#">48</a>
FirePro® AIS	<a href="#">48</a>
FirePro® Compound	<a href="#">49</a>
FirePro® HES	<a href="#">49</a>
FirePro® PWRoll	<a href="#">49</a>
FirePro® Pipe Collar	<a href="#">50</a>
FirePro® Rapid Seal	<a href="#">50</a>
FirePro® Socket Putty Pad	<a href="#">51</a>
FirePro® Flex Seal	<a href="#">51</a>
<b>EXISTING RANGE</b>	
FirePro® Silicone X	<a href="#">54</a>
FirePro® Insulated Fire Sleeves	<a href="#">54</a>
FirePro® Insulated Fire Duct Sleeves	<a href="#">55</a>
FirePro® Intumescent Pillow CE	<a href="#">55</a>
<b>BUILDING SERVICES &amp; HVAC PRODUCTS</b>	<a href="#">56</a>
DuctSlab and DuctWrap	<a href="#">57</a>
DuoDuct Slab	<a href="#">57</a>
DuctRock® Slab	<a href="#">58</a>
RockLap H&V Pipe Sections	<a href="#">60</a>
RockLap H&V Pipe Supports	<a href="#">62</a>
Techwrap	<a href="#">64</a>
Fire Duct System	<a href="#">64</a>

# Terms and conditions

At ROCKWOOL, we have been manufacturing and stocking products locally for over 40 years. Our aim at all times is to give you the best possible customer experience.

To help offer you the very best service, we hold stocks in our expanded Logistics Centre in Bridgend of the most popular products. Everything contained in this price list is a stocked item unless it has been designated as Made to Order.

## In stock

Delivery times for In Stock items will be communicated within the order confirmation provided.

If your order is made up of a mixture of In Stock and Made to Order products, the order will be delivered in line with the longest lead time.

The minimum order quantity will consist of one pallet of a single product thickness, unless otherwise stated.

## Made to Order

Identified by a • symbol.

We know that occasionally you need something that's a little out of the ordinary, so we've also listed a selection of Made to Order products – these are labelled within the product tables.

Delivery times for Made to Order items will be communicated within the order confirmation provided.

If your order is made up of a mixture of In Stock and Made to Order products, the order will be delivered in line with the longest lead time.

Orders for Made to Order products cannot be accepted for less than the minimum order quantity displayed. The full order quantity must be taken as part of a single order which may be taken over multiple deliveries over a one month period.

Once ordered, Made to Order products cannot be cancelled, and the full costs will be applied.

Whilst every effort has been made to ensure the accuracy of this price list and its contents, ROCKWOOL reserves the right to alter in the event of any errors or omissions. All prices listed are exclusive of VAT. E&OE.

For our full Terms and Conditions please visit [rockwool.com/uk/tandcs](http://rockwool.com/uk/tandcs)

## Non-Standard Products

Bespoke products not listed within this price list are defined as "Non-Standard Products."

Due to the nature of Non-Standard Products, prices and minimum order quantities will only be confirmed on request (within 5 working days). Lead times will be communicated in the same way as Made to Order items.

Orders for Non-Standard Products cannot be accepted for less than the confirmed minimum order quantity. The full order must be taken as part of a single order which may be taken over multiple deliveries within a period of one month.

## Fabrication plant

Products manufactured in our fabrication plants are subject to a different delivery service. Please see product listing for more information.

Lead times for fabricated products can vary and will be confirmed on receipt of order.

## Re-stocking/Returns

In exceptional circumstances and at our discretion, some stocked products may be returned. You will be responsible for the cost of collection of any agreed returns, and a re-stocking fee of a minimum of 25% of the list price will apply. A credit note will only be supplied if the product returned is in a saleable condition.

Made to Order and Non-Standard products cannot be returned.

## Customer support – aftercare

For POD's, invoice queries, delivery ETA's and complaints, please contact:

**E-mail:** [aftercare@rockwool.com](mailto:aftercare@rockwool.com)

**Telephone:** 01656 868 400 (option 2)

### Opening times:

Monday: 6.30am-5pm

Tuesday: 6.30am-5pm

Wednesday: 6.30am-5pm

Thursday: 6.30am-5pm

Friday: 6.30am-4pm

For complaints related to product quality, please include as much information as possible to help us investigate – material batch number from product label, quantity of material under issue, PO number, and images of the issue under concern.



# Delivery



Whether delivering to yard or direct to site, ROCKWOOL has a variety of delivery option designed to meet your needs.

## Delivery charges

All full load deliveries are made free of charge (UK mainland only). Deliveries of less than one full load will incur charges as outlined below.

Pallet size:		2400mm x 1200mm 1200mm x 1200mm	2000mm x 1200mm 2000mm x 1000mm	1200mm x 880mm	1300mm x 1200mm	1200mm x 1200mm	1200mm x 1000mm						
Load	Cost	Pallet load: 22		Pallet load: 26		Pallet load: 28		Pallet load: 40		Pallet load: 44		Pallet load: 52	
		Min.	Max.	Min.	Max.	Min.	Max.	Min.	Max.	Min.	Max.	Min.	Max.
Full load	£0	22	22	26	26	28	28	40	40	44	44	52	52
60-99%	£180	13	21	16	25	17	27	24	39	26	43	31	51
50-59%	£210	11	12	13	15	14	16	20	23	22	25	26	30
25-49%	£290	6	10	7	12	7	13	10	19	11	21	13	25
0-24%	POA	1	5	1	6	1	6	1	9	1	10	1	12

Need help planning your delivery load? Why not use our online load calculator? [rockwool.com/uk/loadcalc](http://rockwool.com/uk/loadcalc)

## Half loads

Subject to availability and to the costs shown in the table above, half loads or more qualify for a timed delivery within a two hour window.

Loads which are less than half full are scheduled over a five working days period. You can secure a timed delivery within a two hour window for an additional charge of £290.

## Collections

Collections in a suitable vehicle can be arranged from ROCKWOOL in Pencoed, Bridgend, between 7am and 12 noon, Monday to Friday.

The ROCKWOOL Customer Support Centre will provide information on this service as required.

**Please note:** all other terms and conditions remain the same.

## Delivery vehicles

Our standard delivery vehicle is a 16.5m articulated HGV, weighing up to 44T, which may not be suitable for all sites. We aim to offer you the most sustainable, practical, and cost effective delivery service possible, so we have also provided alternative delivery vehicle options for you to select from. If your delivery requires any of the options listed below, please contact our Customer Support Team.

Standard delivery	Alternative delivery options – charges listed are in addition to table above			
16.5m Articulated HGV (44 Tonnes)	Moffett + £210	Flat Bed + POA <small>A crane will be required for offloading.</small>	Urban Trailer + POA	Rigid - POA



## FORS

Deliveries requiring FORS Bronze are available at no extra cost on request. FORS Silver and Gold deliveries are available on request for a surcharge.



# Delivery

## Amending orders

For stocked items, orders can be amended without charge up to 4 working days before dispatch or additional charges will apply.

For Made to Order products, if manufacturing has commenced, orders cannot be cancelled or amended, and the full costs of the products will be applied.

## Cancelled deliveries

No customer order cancellations will be accepted after 3 working days following the date of issue of the order confirmation by ROCKWOOL.

### Stocked Items

- For products which have not been loaded, no charges will apply.
- For products which have been loaded but have not left the site, a minimum handling charge of £100 will apply.
- For products which are in transit for delivery, handling and transport costs will apply and will be confirmed by ROCKWOOL Customer Support Centre at the time of cancellation.

### Made to Order Items

- For products which have not been manufactured, no charges will apply.
- For products which have been manufactured, the full order value will be charged.
- For products which have been manufactured and are in transit for delivery, the full order value plus handling, and transport costs will apply.

## Postponed deliveries

### Stocked Items

The storage charge will be £100 per trailer per day.

### Made to Order items

Storage charges will apply for Made to Order product deliveries that are postponed after the product has been manufactured. The storage charge will be £100 per trailer per day.

## Postponed flat bed deliveries

Deliveries requested on flat bed trailers which are postponed within 48 hours of the agreed delivery date will be subject to postponement charges. Storage charges will apply.

## Refused deliveries

Deliveries which are refused for any reason (e.g. windage, weather conditions, etc) will incur costs which will include the delivery and return charges and ROCKWOOL handling fees.

## Redirected deliveries

Deliveries that are redirected from the agreed delivery destination will incur charges. ROCKWOOL Customer Support Centre will confirm these costs at the time of request.

## Split deliveries

We offer limited split deliveries on request where possible.

- Up to 20 miles between deliveries, from £75.
- Other distances POA.

## Delayed off-loading

Waiting time charges at £75 per hour pro-rata will apply if the delivery vehicle is not off-loaded within two hours of the requested delivery time.



### Please Note:

Where you see this symbol different delivery details apply. Please see associated text for information.

If your order utilises our pallet delivery service, please refer to the tables shown below to calculate your delivery charges.

Orders for the Isle of Wight will be delivered to the port only.

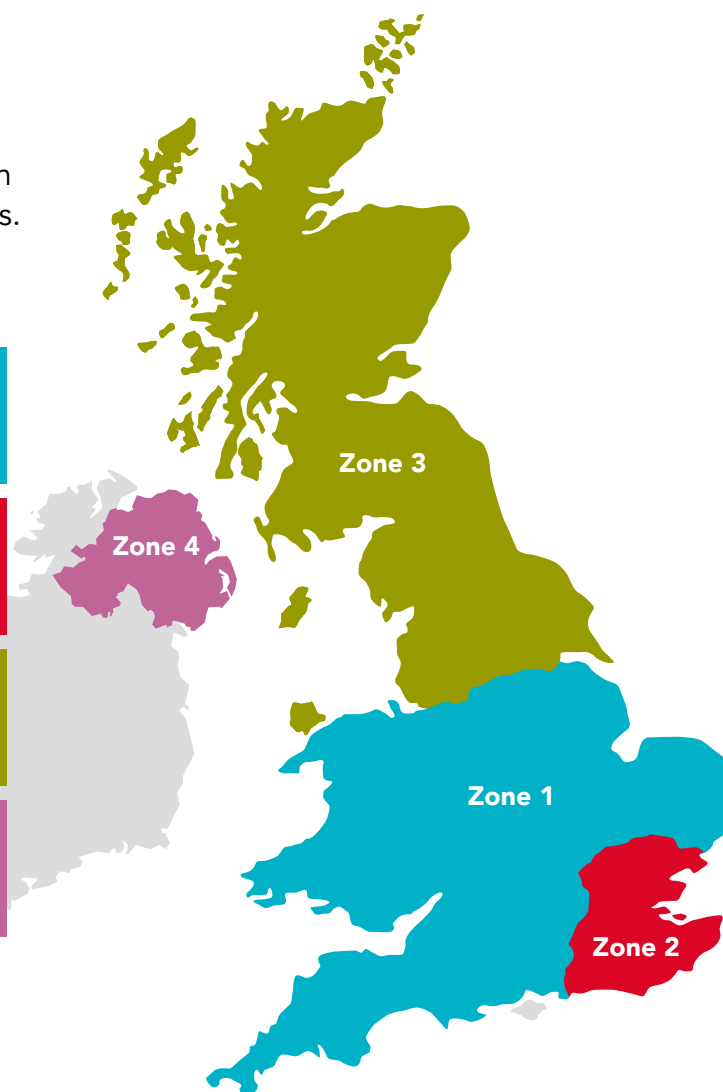

### Zone 1

Wales, South West, Central and East England  
From £70 per pallet

### Zone 2

London and South East England  
From £80 per pallet

### Zone 3

Scotland and North England  
From £90 per pallet

### Zone 4

Northern Ireland  
POA



### Pallet information

The rates detailed are based on a 1200mm x 1200mm pallet.

Prices will be higher for alternative pallet sizes.

The maximum pallet height that can be shipped by courier is 2.29 metres.

### Postcode areas

#### Zone 1

B, BA, BH, BS, CB, CF, CH, CV, CW, DE, DT, DY, EX, GL, HP, HR, IP, LD, LE, LL, LN, LU, MK, NG, NN, NP, NR, OX, PE, PL, PO, RG, SA, SN, SO, SP, ST, SY, TA, TF, TQ, TR, WR, WS, WV

#### Zone 2

AL, BN, BR, CM, CO, CR, CT, DA, E, EC, EN, GU, HA, IG, KT, ME, N, NW, RH, RM, SE, SG, SL, SM, SS, SW, TN, TW, UB, W, WC, WD

#### Zone 3

AB, BB, BD, BL, CA, DD, DG, DH, DL, DN, EH, FK, FY, G, HD, HG, HU, HX, IV, KA, KW, KY, L, LA, LS, M, ML, NE, OL, PA, PH, PR, S, SK, SR, TD, TS, WA, WF, WN, YO

#### Zone 4

BT

# Choose ROCKWOOL non-combustible insulation

## The Euroclass system

The Euroclass Reaction to Fire system classifies building products in accordance with BS EN 13501-2018. A products Reaction to Fire classification can be determined by referring to the Euroclass rating. Products classified A1 or A2-s1, d0 are considered non-combustible and those classified B - F are considered combustible.

**Products are classified from A1-F:**

Euroclass	Combustibility
<b>A1</b> <b>A2-s1, d0</b>	Non-combustible
<b>B</b>	
<b>C</b>	
<b>D</b>	Combustible:
<b>E</b>	Will burn and may char or flame
<b>F</b>	
<b>NPD</b>	

Important points to remember...

- To be sure of a product's Euroclass rating, simply check its Declaration of Performance (DoP).
- All ROCKWOOL DoPs are available online at [rockwool.com/uk/dop/](https://rockwool.com/uk/dop/)

# Your learning, your way



With ROCKWOOL Learning you can:



Expand your knowledge and take control of your learning pathway



Complete courses at your preferred time and location



Access courses designed for all construction stakeholders



**ROCKWOOL®**

**Register today**



[rockwool.com/uk/learning](https://rockwool.com/uk/learning)

Introducing the

# ROCKWOOL TRAINING ACADEMY

Explore best practice learning and hands-on training  
at the new ROCKWOOL Training Academy.

Get started with our expert-led fire-stopping course,  
flexibly designed for all levels of experience.

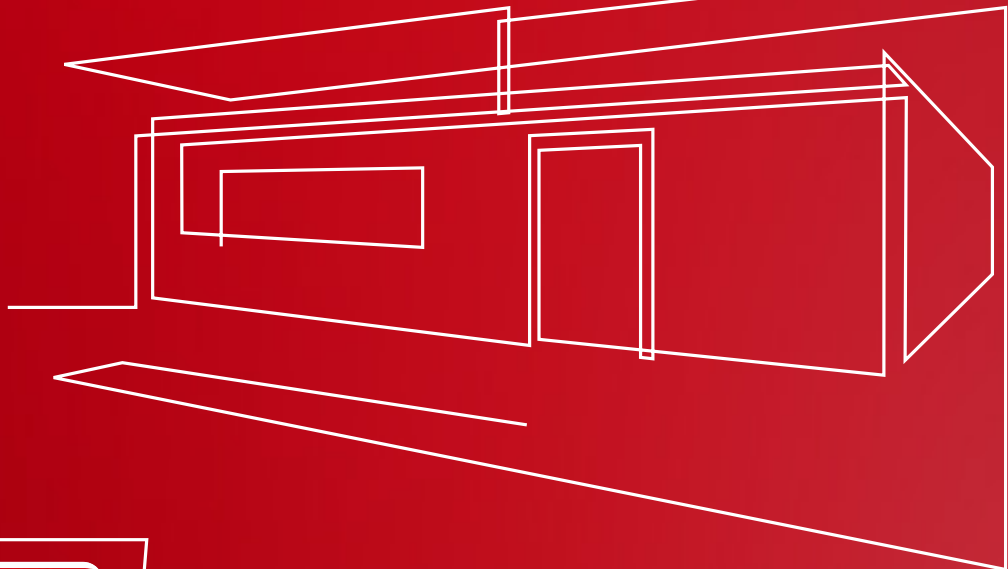

**REGISTER  
YOUR INTEREST**

[rockwool.com/uk/  
training-academy](https://rockwool.com/uk/training-academy)



# ROCKWOOL Resource Hubs

Digital specification support  
for insulation applications.

Use our resource hubs to identify the right  
non-combustible stone wool insulation  
products for specific applications.

Mapped to key insulation  
application areas, the ROCKWOOL  
resource hubs provide access to  
technical tools, data, guidance  
and installation support all in one  
place:



#### FirePro®

When specifying FirePro®  
products, the suite of resources  
provides guidance on all things  
passive fire protection.



#### Ventilated Façade

Bringing together all relevant  
technical literature, the resource  
hub helps specifiers to navigate  
routes to compliance when using  
ventilated façades.



#### Acoustic

Helping to better understand  
the role of building acoustics,  
specialist acoustics resources  
for creating safe and sound  
environments can be found here.



#### Building Services and HVAC

A comprehensive suite of  
resources designed to save time  
and make it easier to deliver  
robust project specifications.



#### Flat Roof

Support the design of flat roof  
insulation with specialist tools,  
guidance, and technical data.



Explore the ROCKWOOL  
resource hubs now.

[rockwool.com/uk/resource-hubs](https://rockwool.com/uk/resource-hubs)

# Cavity solutions



## NyRock® Cavity Slab 032

NyRock Cavity Slab 032 is a full and partial fill stone wool slab developed as thermal insulation for masonry cavity walls. For use in new builds, renovations, or extensions.

Lambda 0.032 W/mK

Pallet size: 1200mm x 1200mm  
\*Pallet size 1200mm x 1000mm for 85mm only

For Partial Fill Applications										
Product code	Thickness (mm)	Width (mm)	Length (mm)	Pieces/ Pack	Area/ Pack (m <sup>2</sup> )	Packs/ Pallet	Area/pallet (m <sup>2</sup> )	Made to Order	MOQ (Pallet)	List price/m <sup>2</sup>
352334	50	455	1200	8	4.37	15	65.52		1	£14.87
348004	75	455	1200	4	2.18	20	43.68	•	22	£22.28
352342*	85	455	1200	4	2.18	15	32.76		1	£25.26
For Full Fill and Partial Fill applications										
326646	100	455	1200	4	2.18	15	32.76		1	£25.84
326652	125	455	1200	3	1.64	15	24.57		1	£32.30
326657	150	455	1200	2	1.09	20	21.84		1	£38.76
330079	160	455	1200	2	1.09	20	21.84		1	£43.42
326660	200	455	1200	2	1.09	15	16.38		1	£51.68

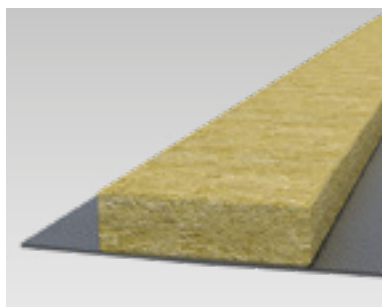

## RockClose EN

RockClose EN is an insulated cavity closer developed to minimise thermal bridging around windows and doors and also acts to inhibit the passage of smoke and fire within masonry, timber, and steel frame constructions.

DPC length: 1300mm. DPC width: 180mm. Pallet size: 1200mm x 1200mm

Product code	Suitable for maximum cavity width (mm)	RockClose EN dimensions (mm)			Linear m/ Pallet	Made to Order	MOQ (Linear m)	List price/ Linear m
		Thickness (mm)	Width (mm)	Length (mm)				
356947	20	30	100	1200	720	•	200	£47.51
356950	30	40	100	1200	528	•	200	£48.35
356951	40	50	100	1200	432	•	200	£49.19
356953	50	60	100	1200	336	•	200	£52.13



RockClose® orders cannot be used to contribute towards mixed loads.  
The lead times for these products can vary and will be confirmed on receipt of order.  
A carriage charge of £50 will apply to orders with a net value below £500.



## Full Fill Cavity Batt

Full Fill Cavity Batt is non-combustible and contains water repellent additives which prevent moisture transmission between the outer and inner leaf.

Lambda 0.037 W/mK

Pallet size: 1200mm x 1200mm

Product code	Thickness (mm)	Width (mm)	Length (mm)	Pieces/ Pack	Area/ Pack (m <sup>2</sup> )	Packs/ Pallet	Area/ Pallet (m <sup>2</sup> )	Made to Order	MOQ (Pallet)	List price/m <sup>2</sup>
122878	50	455	1200	12	6.55	15	98.28			£10.04
122880	75	455	1200	9	4.91	15	73.71			£12.47
122881	80	455	1200	8	4.37	15	65.52			£12.92
122883	100	455	1200	6	3.28	25	81.90			£16.11
122888	150	455	1200	4	2.18	25	54.60	•	22	£26.14

# Frame solutions

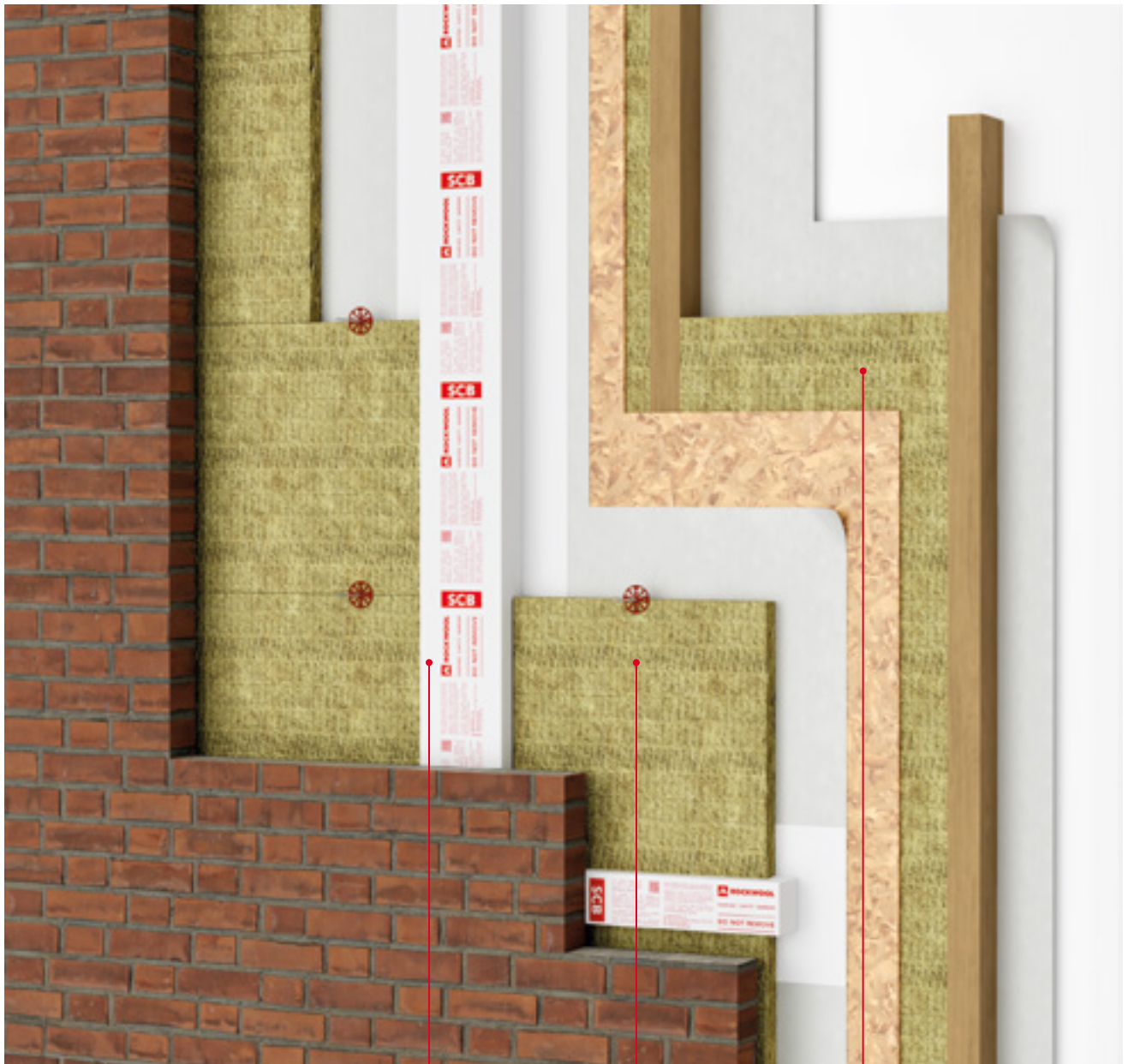

SCB (Sleeved  
Cavity Barrier)

NyRock®  
Rainscreen 032

NyRock®  
Frame 032

ROCKWOOL frame slabs are manufactured using a unique high-speed spinning process to produce stone wool insulation that is low lambda, to help meet demanding thermal performance requirements.

The slabs are sound absorbent and are Euroclass A1 non-combustible. Available in a variety of widths and thicknesses to suit the typical stud apertures of timber and steel frame constructions.

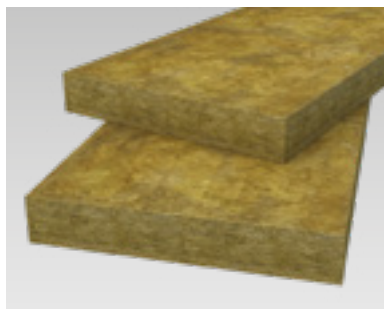

## NyRock® Frame Slab 032

NyRock Frame Slab 032 is a semi-rigid stone wool insulation slab designed specifically for use between the studwork of external timber or light gauge steel frame walls.

Manufactured using NyRock® technology, the slabs deliver insulation offering a low thermal conductivity designed to help meet thermal building regulations.

Lambda 0.032 W/mK

Pallet size: 1200mm x 1200mm

Product code	Thickness (mm)	Width (mm)	Length (mm)	Pieces/ Pack	Area/ Pack (m <sup>2</sup> )	Packs/ Pallet	Area/ Pallet (m <sup>2</sup> )	Made to Order	MOQ (Pallet)	List price/m <sup>2</sup>
326566	90	570	1200	4	2.74	12	32.83	•	22	£20.14
326599	140	570	1200	3	2.05	12	24.62			£30.62
323861	100	600	1200	3	2.16	16	34.56			£20.83
326570	120	600	1200	2	1.44	20	28.80		1	£24.94
326600	150	600	1200	2	1.44	16	23.04			£31.22



## Timber Frame Slab

ROCKWOOL Timber Frame Slab is non-combustible, semi-rigid thermal insulation, designed specifically for use between the studwork of external timber frame walls.

Lambda 0.034 W/mK

Pallet size: 1200mm x 1200mm

Product code	Thickness (mm)	Width (mm)	Length (mm)	Pieces/ Pack	Area/ Pack (m <sup>2</sup> )	Packs/ Pallet	Area/ Pallet (m <sup>2</sup> )	Made to Order	MOQ (Pallet)	List price/m <sup>2</sup>
278730	90	570	1200	6	4.1	12	49.25	•	22	£15.50
278728	140	570	1200	4	2.74	12	32.83			£23.57



## Steel Frame Slab

Developed for external wall installations, ROCKWOOL Steel Frame Slab can help to meet the requirements (thermal) of Part L of the Building Regulations, by delivering a thermal conductivity of 0.034 W/mK. The slabs are supplied in 600mm widths. This ensures a tight friction fit into standard frames, with no gaps.

Lambda 0.034 W/mK

Pallet size: 1200mm x 1200mm

Product code	Thickness (mm)	Width (mm)	Length (mm)	Pieces/ Pack	Area/ Pack (m <sup>2</sup> )	Packs/ Pallet	Area/ Pallet (m <sup>2</sup> )	List price/m <sup>2</sup>
278727	100	600	1200	6	4.32	12	51.84	£16.02
278712	120	600	1200	5	3.60	12	43.20	£19.19
278725	150	600	1200	4	2.88	12	34.56	£24.03

# Cladding solutions

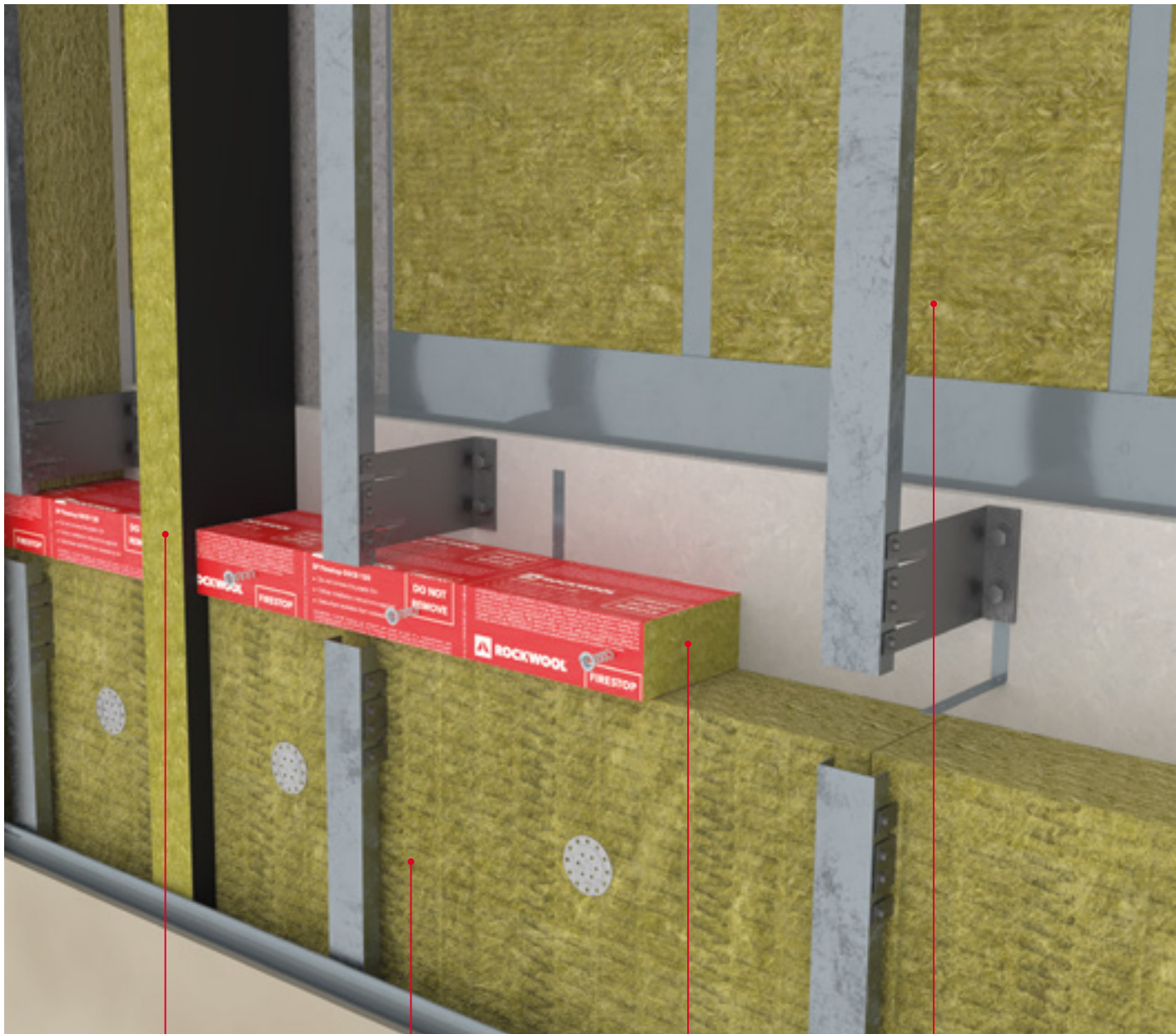

SP FireStop EN

RainScreen Duo Slab or  
NyRock Rainscreen 032

SP FireStop  
OSCB

Steel Frame Slab  
or NyRock  
Frame Slab 032

ROCKWOOL cladding solutions offer lightweight thermal, fire, and acoustic cladding insulation suitable for external wall and roof applications.

These include ventilated façade systems and built-up metal wall and roof systems. The ROCKWOOL range of cladding insulation delivers fire protection and acoustic performance, and are available in a variety of thicknesses.

*For detailed information on product performance, please refer to the individual product datasheets.*

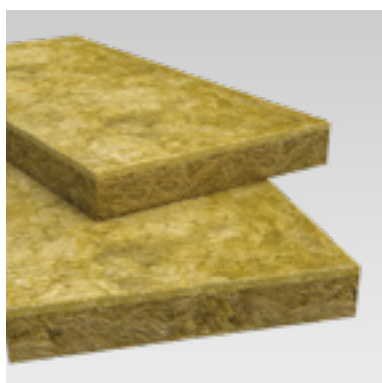

## RainScreen Duo Slab®

RainScreen Duo Slab® is a dual-density insulation board which has been developed for use in cladding applications, especially in conditions of climatic exposure.

Lambda 0.035 W/mK, Lambda 0.034 W/mK\*

Pallet size: 1200mm x 1200mm

	Product code	Thickness (mm)	Width (mm)	Length (mm)	Pieces/ Pack	Area/ Pack (m <sup>2</sup> )	Packs/ Pallet	Area/ Pallet (m <sup>2</sup> )	Made to Order	MOQ (Pallet)	List price/m <sup>2</sup>
	221343*	50	600	1200	8	5.76	12	69.12			£27.49
	221347*	60	600	1200	6	4.32	12	51.84			£32.79
	221352*	75	600	1200	6	4.32	12	51.84			£41.11
	283606*	80	600	1200	4	2.88	16	46.08			£47.90
	221359	90	600	1200	4	2.88	12	34.56			£50.42
	221361	100	600	1200	4	2.88	12	34.56			£51.94
	225556	110	600	1200	4	2.88	12	34.56			£58.29
	300182	120	600	1200	4	2.88	12	34.56			£62.40
	300183	125	600	1200	4	2.88	12	34.56			£62.67
	251046	130	600	1200	3	2.16	12	25.92	•	22	£71.98
	251257	140	600	1200	3	2.16	12	25.92			£74.04
	221334	150	600	1200	3	2.16	12	25.92			£81.69
	251989	160	600	1200	2	1.44	16	23.04	•	22	£82.78
	248930	170	600	1200	2	1.44	16	23.04	•	22	£89.81
	348416	180	600	1200	3	2.16	12	25.92			£97.74
	235884	190	600	1200	2	1.44	12	17.28	•	22	£104.68
	247869	200	600	1200	2	1.44	12	17.28			£108.50
	235883	220	600	1200	2	1.44	12	17.28	•	22	£114.15
	239219	225	600	1200	2	1.44	12	17.28	•	22	£116.03
◆	254360	180	600	1000	3	1.80	10	18	•	22	£118.25

KEY: ◆ ALU Faced



## NyRock® Rainscreen 032

NyRock® Rainscreen 032 is specifically developed for use within ventilated cladding systems, as well as sealed systems such as curtain walling.

The product can be fitted around brackets and other awkward details, and when tightly butted, adjacent slabs effectively 'knit' together to provide a continuous insulating layer, reducing heat losses that would otherwise be caused by gaps.

Lambda 0.032 W/mK

Pallet size: 2400mm x 1200mm

Product code	Thickness (mm)	Width (mm)	Length (mm)	Pieces/ Pack	Area/ Pack (m <sup>2</sup> )	Packs/ Pallet	Area/ Pallet (m <sup>2</sup> )	Made to Order	MOQ (Pallet)	List price/m <sup>2</sup>
326324	50	600	1200	6	4.32	16	69.12	•	22	£33.14
328258	60	600	1200	6	4.32	12	51.84	•	22	£39.51
326354	70	600	1200	4	2.88	16	46.08	•	22	£46.17
326361	75	600	1200	4	2.88	16	46.08			£49.53
326362	80	600	1200	4	2.88	16	46.08			£57.73
328260	85	600	1200	3	2.16	20	43.2	•	22	£59.37
326364	90	600	1200	4	2.88	12	34.56			£60.76
326367	100	600	1200	3	2.16	16	34.56			£62.60
328261	110	600	1200	3	2.16	12	25.92			£70.26
326372	115	600	1200	3	2.16	12	25.92	•	22	£71.47
326376	125	600	1200	3	2.16	12	25.92			£75.55
326381	135	600	1200	3	2.16	12	25.92			£85.10
326383	150	600	1200	2	1.44	16	23.04			£98.46
326385	165	600	1200	2	1.44	12	17.28	•	22	£108.15
326395	180	600	1200	2	1.44	12	17.28	•	22	£117.81
326396	200	600	1200	2	1.44	12	17.28			£130.77



## Cladding Roll

Cladding Roll is a lightweight, flexible mat which delivers a combination of thermal, fire, and acoustic performance. Developed for use within built-up metal roof and wall applications, Cladding Roll is available in a variety of thicknesses and can be produced with an aluminium facing to provide tensile strength in vertical wall applications.

Lambda 0.040 W/mK

Pallet size: 1000mm x 1000mm

Product code	Thickness (mm)	Width (mm)	Length (mm)	Pieces/ Pack	Area/ Pack (m <sup>2</sup> )	Packs/ Pallet	Area/ Pallet (m <sup>2</sup> )	Made to Order	MOQ (Pallet)	List price/m <sup>2</sup>
369805	60	1000	3200	2	6.4	21	138.24			£7.93
369760	80	1000	5000	1	5	21	108	•	22	£10.35
369766	100	1000	4800	1	4.8	21	103.68			£12.40
369767	120	1000	4000	1	4	21	86.4	•	22	£14.96
369768	150	1000	3200	1	3.2	21	69.12			£19.16
255780*	150	1000	3200	1	3.2	21	67.2	•	22	£29.08
369769	180	1000	2700	1	2.7	21	58.32			£22.31

\*Foil faced. For vertical applications, we would strongly advise the use of foil faced Cladding Roll.

# Ny and improved



The most thermally efficient stone wool for external walls currently available in the UK and Ireland†.



Patented ROCKWOOL® NyRock technology powering low lambda, non-combustible stone wool for thinner wall construction



Euroclass A1, non-combustible



Proven to deliver consistent thermal performance for the lifetime of the building\*



Independently tested acoustic performance, reducing up to  $R_w$  60 dB\*\*

\*FIW (German test and research institute), Durability Project Mineral Wool, 2016 \*\*NyRock Rainscreen 032. †Correct at time of sending, based on publicly available performance data of comparable stone wool products.

Choose NyRock.



  
rockwool.com/uk



## SP FireStop OSCB 25

Specifically designed for use only in conjunction with either RainScreen Duo Slab® or NyRock® Rainscreen 032, SP FireStop OSCB 25\* forms an open-state cavity fire barrier within the building façade, allowing for an open cavity of up to 25mm for ventilation and drainage.

\* Product codes for SP FireStop OSCB 25 will be supplied on receipt of order.

Prices indicated are inclusive of stainless steel pigtail screws and galvanised steel fixing brackets. These items are supplied in a box located at the bottom of a clearly marked pallet. Stainless steel brackets are available at an extra cost of £2.79 per linear metre - please specify when ordering if these are required.

Please contact the ROCKWOOL Customer Support Team for further information.

Length: 1000mm. Depth: 90mm

Width dimensions (mm)		List price
Product	Max. overall cavity	
75	100	£36.52
80	105	£37.02
85	110	£37.47
90	115	£37.73
95	120	£38.06
100	125	£38.71
105	130	£39.10
110	135	£39.54
115	140	£39.68
120	145	£40.44
125	150	£40.64
130	155	£41.12
135	160	£41.67
140	165	£41.88
145	170	£42.07
150	175	£43.17
155	180	£43.27
160	185	£43.56
165	190	£43.70
170	195	£45.10
175	200	£45.22
180	205	£45.51
185	210	£45.71
190	215	£45.85
195	220	£46.04
200	225	£47.83
205	230	£48.10
210	235	£48.31
215	240	£48.44
220	245	£48.63
225	250	£48.79
230	255	£48.96
235	260	£49.12
240	265	£51.97
245	270	£52.10
250	275	£52.29
255	280	£52.43
260	285	£52.62
265	290	£52.76
270	295	£52.98
275	300	£53.20
280	305	£53.30

Width dimensions (mm)		List price
Product	Max. overall cavity	
285	310	£53.50
290	315	£53.91
295	320	£54.06
300	325	£58.35
305	330	£58.48
310	335	£58.66
315	340	£58.80
320	345	£59.00
325	350	£59.23
330	355	£59.36
335	360	£59.58
340	365	£59.67
345	370	£59.89
350	375	£60.04
355	380	£60.22
360	385	£60.77
365	390	£60.96
370	395	£61.17
375	400	£61.32
380	405	£61.53
385	410	£61.64
390	415	£61.86
395	420	£61.98
400	425	£70.32
405	430	£70.53
415	440	£70.86
425	450	£71.20
435	460	£71.56
445	470	£71.94
455	480	£72.28
465	490	£72.61
475	500	£72.99
485	510	£74.10
495	520	£74.47
505	530	£74.81
515	540	£75.14
525	550	£75.45
535	560	£75.88
545	570	£76.21
555	580	£76.54
565	590	£76.89
575	600	£77.26



OSCB orders cannot be used to contribute towards mixed loads. These products are delivered direct from our fabrication plant. OSCB orders for less than £300 net will incur an additional charge of £25. The lead times for these products can vary and will be confirmed on receipt of order.

\* For voids equal to 425mm and up to 600mm, a minimum thickness of 300mm of Rainscreen Duo Slab/NyRock Rainscreen 032 is required both above and below the cavity barrier.



## SP FireStop OSCB 44

Specifically designed for use only in conjunction with either RainScreen Duo Slab® or NyRock® Rainscreen 032, SP FireStop OSCB 44\* forms an open-state cavity fire barrier within the building façade, allowing for an open cavity of up to 44mm for ventilation and drainage.

\* Product codes for the OSCB 44 will be supplied on receipt of the order.

Prices indicated are inclusive of galvanised steel fixing brackets. OSCB 44 does not require pigtail screws. The brackets are supplied in a box located at the bottom of a clearly marked pallet. Stainless steel brackets are available at an extra cost of £2.79 per linear metre - please specify when ordering if these are required. Please contact the ROCKWOOL Customer Support Team for further information.

Length: 1000mm. Depth: 90mm

Width dimensions (mm)		List price
Product	Max. overall cavity	
31	75	£57.61
56	100	£59.32
61	105	£59.67
66	110	£60.04
71	115	£60.45
76	120	£60.80
81	125	£61.17
86	130	£61.57
91	135	£61.76
96	140	£62.15
101	145	£62.63
106	150	£62.83
111	155	£63.37
116	160	£63.54
121	165	£64.12
126	170	£64.33
131	175	£64.50
136	180	£65.19
141	185	£65.38
146	190	£65.55
151	195	£66.44
156	200	£66.58
161	205	£66.82
166	210	£67.00
171	215	£67.13
176	220	£68.28
181	225	£68.52
186	230	£68.67
191	235	£68.81
196	240	£68.98
201	245	£70.46
206	250	£70.71
211	255	£70.89
216	260	£71.05

Width dimensions (mm)		List price
Product	Max. overall cavity	
221	265	£71.18
226	270	£71.38
231	275	£71.52
236	280	£71.69
241	285	£74.03
246	290	£74.14
251	295	£74.33
256	300	£74.50
261	305	£74.59
266	310	£74.81
271	315	£74.92
276	320	£75.09
281	325	£75.21
286	330	£75.66
291	335	£75.76
296	340	£75.95
301	345	£79.47
306	350	£79.64
311	355	£79.76
316	360	£79.95
321	365	£80.08
326	370	£80.25
331	375	£80.34
336	380	£80.55
341	385	£80.74
346	390	£80.85
351	395	£81.05
356	400	£81.14
361	405	£81.70
366	410	£81.81
371	415	£82.01
376	420	£82.13
381	425	£82.28

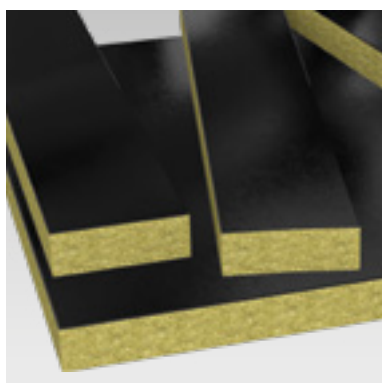

## SP FireStop EN

SP FireStop EN has been tested in accordance with BS EN 1366-4:2021 and is suitable for use as a linear cavity firestop in both vertical and horizontal orientations. SP FireStop EN has been tested with multiple substrate types, including masonry/concrete, SFS, and composite panels with a stone wool core. SP FireStop EN has also been tested in accordance with BS EN 1364-4:2014, curtain walling - part configuration.

For pricing and further information please refer to [page 40](#).

For detailed information on product performance, please refer to the product datasheet.

# ROCKWOOL SP FireStop EN

**A linear cavity fire stopping solution suitable for vertical and horizontal installation.**

- Tested for use with steel frame substrates, composite panels, and masonry
- Up to 120 minutes integrity and insulation in cavities up to 600mm\*
- Tested to BS EN 1366-4:2021 and BS EN 1364-4:2014
- Suitable for 'installation from below'



\*Subject to the application

**Find out more:**

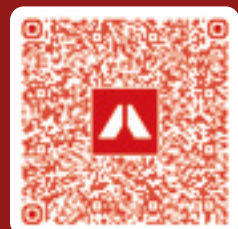

[rockwool.com/uk/  
sp-firestop-en](https://rockwool.com/uk/sp-firestop-en)



[rockwool.com/uk](https://rockwool.com/uk)

[< Back to Contents page](#)

# Flat Roof solutions

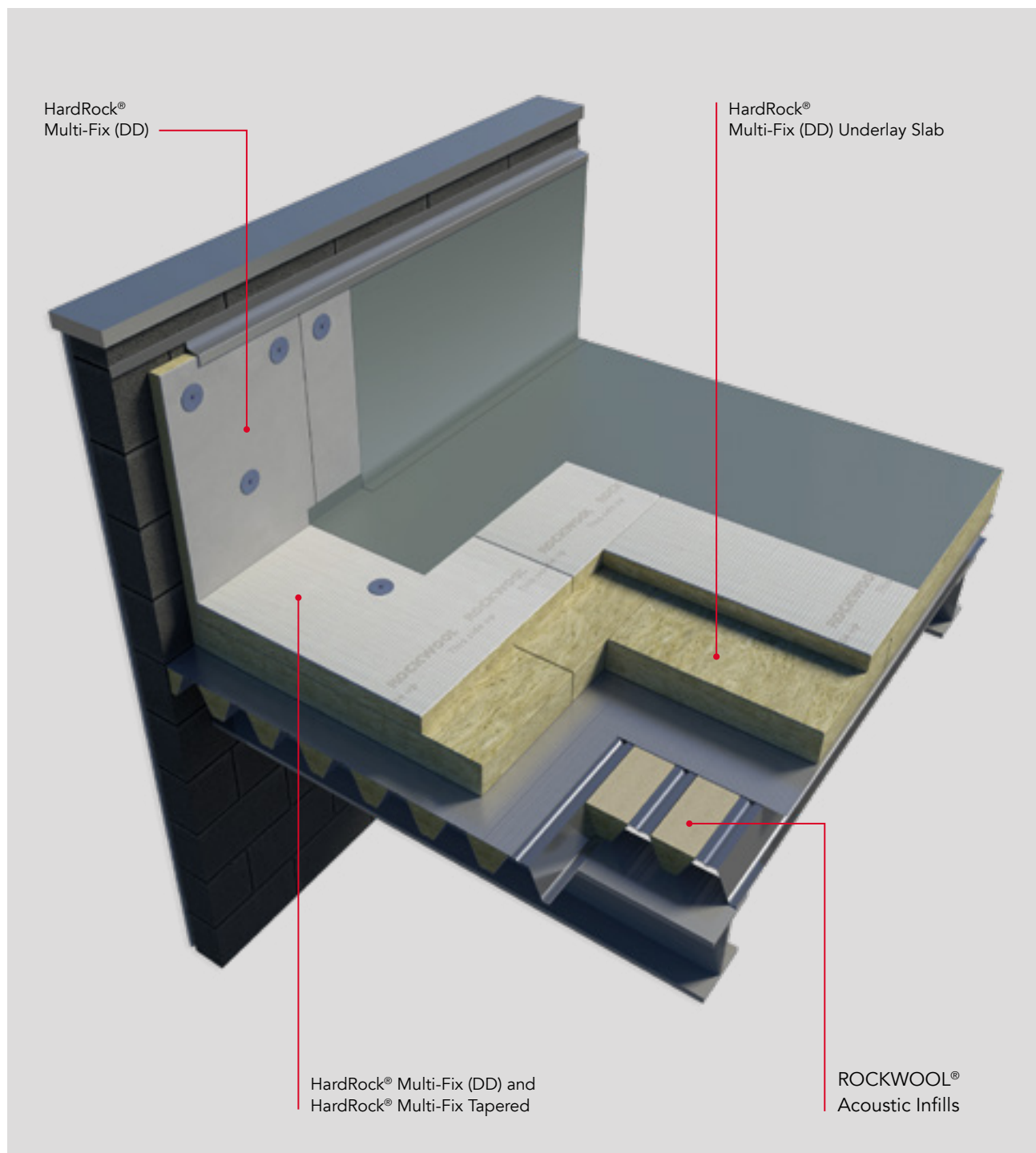

ROCKWOOL flat roof solutions have been designed to meet the demands of modern roof systems, offering tested, durable solutions.

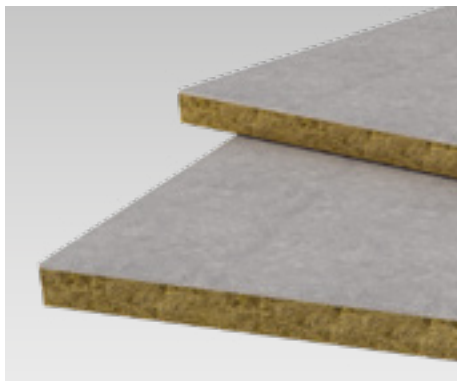

## HardRock® UB34

Consisting of non-combustible ROCKWOOL insulation faced with an exterior grade non-combustible 6mm fibre cement board, HardRock UB34 achieves a Euroclass fire classification of A2, s1-d0, offering a non-combustible solution for insulating upstands and parapet walls.

Lambda 0.034 W/mK

Pallet size: 2400mm x 1200mm

Product code	Additional information	Thickness (mm)	Width (mm)	Length (mm)	Pieces/Pallet	Area/Pallet (m <sup>2</sup> )	Made to Order	MOQ (Pallet)	List price/m <sup>2</sup>
284556	6mm exterior grade fibre cement board	56	600	1200	72	51.84	•	1	£149.90

When it comes to specifying non-combustible insulation, the majority of focus has been on external walls – but overlooking the roof could introduce a weak link into the building envelope. According to government reports, between 2010 and 2018 there were 4,290 fires in England where the roof was deemed to have been “mainly responsible for the development of the fire”.\* We urge you to push the envelope and specify ROCKWOOL on your build as it is just as important to have non-combustible, thermally efficient insulation on the roof as it is on the façade.

**Lisa Stephens, Product Manager – Flat Roof & Façades**

\*Source: gov.uk - FIRE0603: Primary fires fatalities and non-fatal casualties by item first ignited.

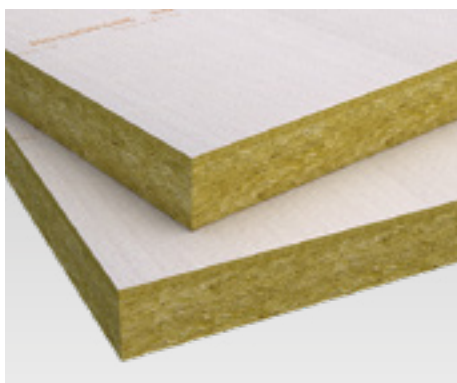

## HardRock® Multi-Fix (DD)

HardRock® Multi-Fix (DD) is a BBA-approved stone wool insulation board faced with a mineral-coated white fleece, compatible with a wide range of adhered and mechanically-fixed waterproofing systems - including bitumen, single-ply, EPDM, and liquid membranes, as well as green roof systems.

HardRock® Multi-Fix (DD) can also be used above rafters for warm pitched roof applications.

Lambda 0.039 W/mK

Pallet size: 1200mm x 1000mm

Product code	Thickness (mm)	Width (mm)	Length (mm)	Pieces/Pallet	Area/Pallet (m <sup>2</sup> )	MOQ (Pallet)	List price/m <sup>2</sup>
138230	60	1000	1200	20	24.00	1	£43.53
133134	85	1000	1200	15	18.00	1	£54.82
132664	105	1000	1200	12	14.40	1	£65.17
138250	115	1000	1200	10	12.00	1	£71.39
133090	150	1000	1200	8	9.60	1	£88.47
136405	185	1000	1200	6	7.20	1	£107.41

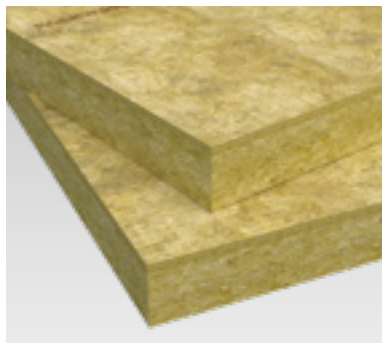

## HardRock® Multi-Fix (DD) Underlay Slab

Designed to be installed with HardRock® Multi-Fix DD, HardRock® Underlay Slab forms a base layer within multi-layer solutions. Manufactured from non-combustible stone wool, this product will contribute to the thermal, acoustic, and fire performance of a flat roof system.

For further information on product performance, please refer to the product datasheet.

Lambda 0.039 W/mK

Pallet size: 1200mm x 1000mm

Product code	Thickness (mm)	Width (mm)	Length (mm)	Pieces/Pallet	Area/Pallet (m <sup>2</sup> )	MOQ (Pallet)	List price/m <sup>2</sup>
155103	120	1000	1200	10	12.00	52	£69.21
138251	150	1000	1200	8	9.60	1	£81.92
216597	170	1000	1200	7	8.40	52	£97.92



## HardRock® Multi-Fix Recovery Board

HardRock® Multi-Fix Recovery Board has been developed to simplify the repair and refurbishment of flat roof systems. The product can be used to isolate and prepare the surface of existing roof systems, providing a level surface for the installation of new waterproofing membranes.

HardRock® Multi-Fix Recovery Board is compatible with all commonly used flat roof membranes, including single ply, EPDM, bitumen, and liquid membrane systems (including GRP).

Lambda 0.039 W/mK

Pallet size: 1200mm x 1000mm

Product code	Thickness (mm)	Width (mm)	Length (mm)	Pieces/Pallet	Area/Pallet (m <sup>2</sup> )	MOQ (Pallet)	List price/m <sup>2</sup>
174879	30	1000	1200	40	48	1	£19.51

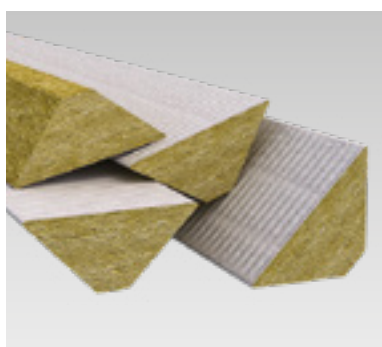

## HardRock® Multi-Fix Angle Fillets

Manufactured from high-density, fire-resilient ROCKWOOL insulation, and faced with a white mineral-coated glass fibre fleece, HardRock® Multi-Fix Angle Fillets are developed to support bituminous waterproof membranes at 90° abutments.

The smooth transitions allow water to run off freely, as opposed to holding in corners, where it could potentially seep into the building and cause structural damage.

Pallet size: 1200mm x 1200mm

Product code	Thickness (mm)	Width (mm)	Length (mm)	Pieces/Box	MOQ (Box)	List price/Linear m
292007	30	75	1200	75	1	£4.73



Orders for HardRock® UB34 & HardRock® Multi-Fix Angle Fillets cannot be used to contribute towards mixed loads. The lead times for these products can vary and will be confirmed on receipt of order. Additional carriage charges may be applied.

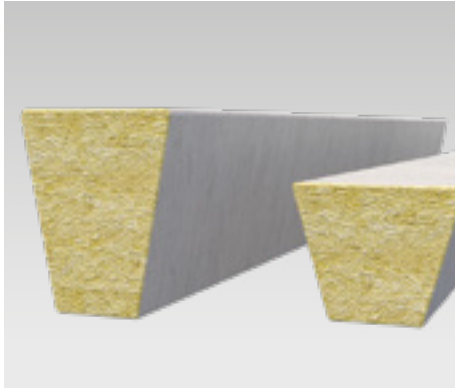

## Acoustic Infills

ROCKWOOL® Acoustic Infills consist of a trapezoidal shaped ROCKWOOL insulation which can be engineered to suit all types of perforated metal roof deck profiles.

Acoustic Infills provide a high-density, fibrous solution that delivers sound absorption, designed and tested for use within ROCKWOOL HardRock® roof systems.

*For further information on acoustic performance, please refer to the product datasheet. Acoustic Infills for different deck types, such as those from Joricide, Euroclad, and Firth Steels, can be made to order subject to minimum order quantities. For further details please contact your local ROCKWOOL sales representative.*

Tissue Faced White

Pallet size: 1200mm x 1200mm

Product code	Deck type	Length	Dimensions (mm)			Pieces/ Pallet	MOQ (Pallet)	List price/ Linear m
			Major	Minor	Thickness			
303802	TATA D32	1200	68	23	25	952	1	£4.84
303922	TATA D46	1200	116	63	40	340	1	£6.86
303994	TATA D60	1200	106	60	50	275	1	£7.31
303997	TATA D100	1200	120	59	97	140	1	£9.15
303999	TATA D137	1200	161	39	125	90	1	£11.89
304799	TATA D153	1200	157	36	150	81	1	£11.92
304800	TATA D158	1200	128	37	150	99	1	£11.92
304802	TATA D159	1200	138	34	150	99	1	£11.51
304804	TATA D200	1200	166	71	195	56	1	£15.52



Acoustic infill orders cannot be used to contribute towards mixed loads.  
Lead times for these products can vary and will be confirmed on receipt of order.  
Additional carriage charges may be applied.

# Flat roofs: The functional fifth façade

## Flat roof project? Know the risks.

To make the most of a flat roof by adding solar panels, social spaces, or functional installations, you need to be aware of the fire risks.

Find out how to protect your space.

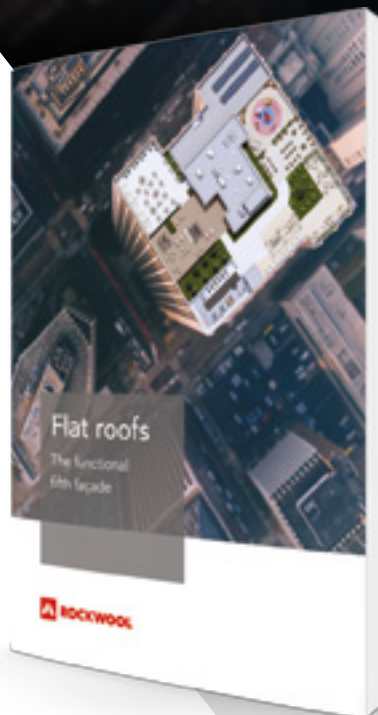

Download the  
whitepaper:



[rockwool.com/uk/  
functionalroofs](https://rockwool.com/uk/functionalroofs)



[X](#) [in](#) [f](#) [@](#) [▶](#)  
[rockwool.com/uk](https://rockwool.com/uk)

[< Back to Contents page](#)

T: 01656 868 400 [Page 29 of 68](#)

# Floor solutions

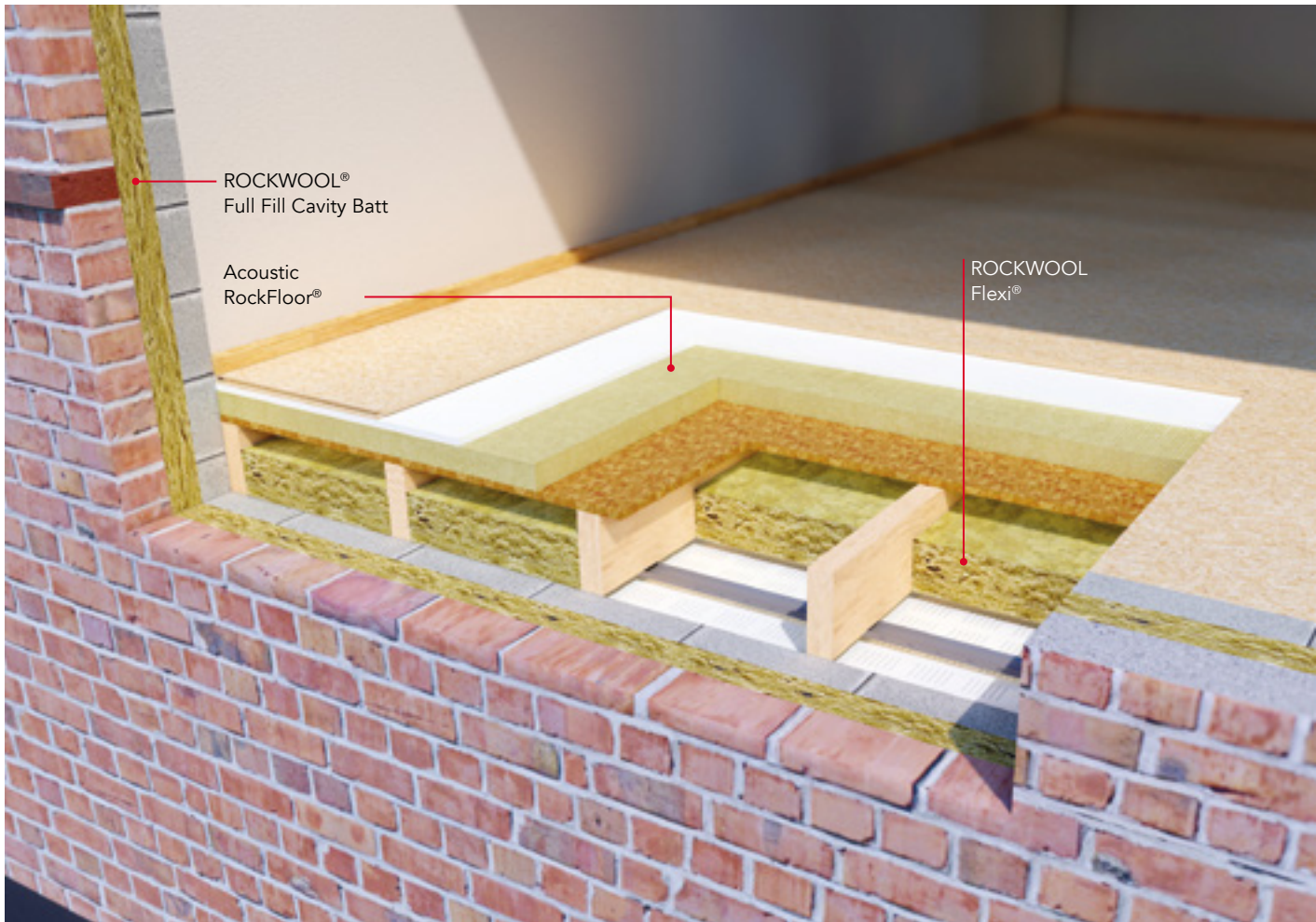

ROCKWOOL insulation offers solutions for all types of floor, including ground floors, separating floors, and intermediate floors.

Energy efficiency and sound management are key to creating comfortable and healthy working and living environments. The thermal and acoustic performance of floor systems is an essential consideration when developing specifications for all building types.



## RockFloor®

RockFloor® solutions are split into two families; Thermal RockFloor®, designed for the thermal insulation of ground and separating floors, and Acoustic RockFloor®, developed to provide sound absorption in internal and separating floors.

### Acoustic RockFloor®

Pallet size: 1200mm x 1000mm

Product code	Thickness (mm)	Width (mm)	Length (mm)	Boards/Pallet	Area/Pallet (m <sup>2</sup> )	Made to Order	MOQ (Pallet)	List price/m <sup>2</sup>
122663	25	600	1000	96	57.60			£34.14
122664	30	600	1000	80	48.00			£36.16
122666	50	600	1000	48	28.80			£61.38

### Thermal RockFloor®

Lambda 0.038 W/mK

Pallet size: 1200mm x 1000mm

Product code	Thickness (mm)	Width (mm)	Length (mm)	Boards/Pallet	Area/Pallet (m <sup>2</sup> )	Made to Order	MOQ (Pallet)	List price/m <sup>2</sup>
125051	50	600	1000	48	28.80			£50.29
125054	80	600	1000	30	18.00	•	15	£60.15
125056	100	600	1000	24	14.40			£70.88



# Roll products

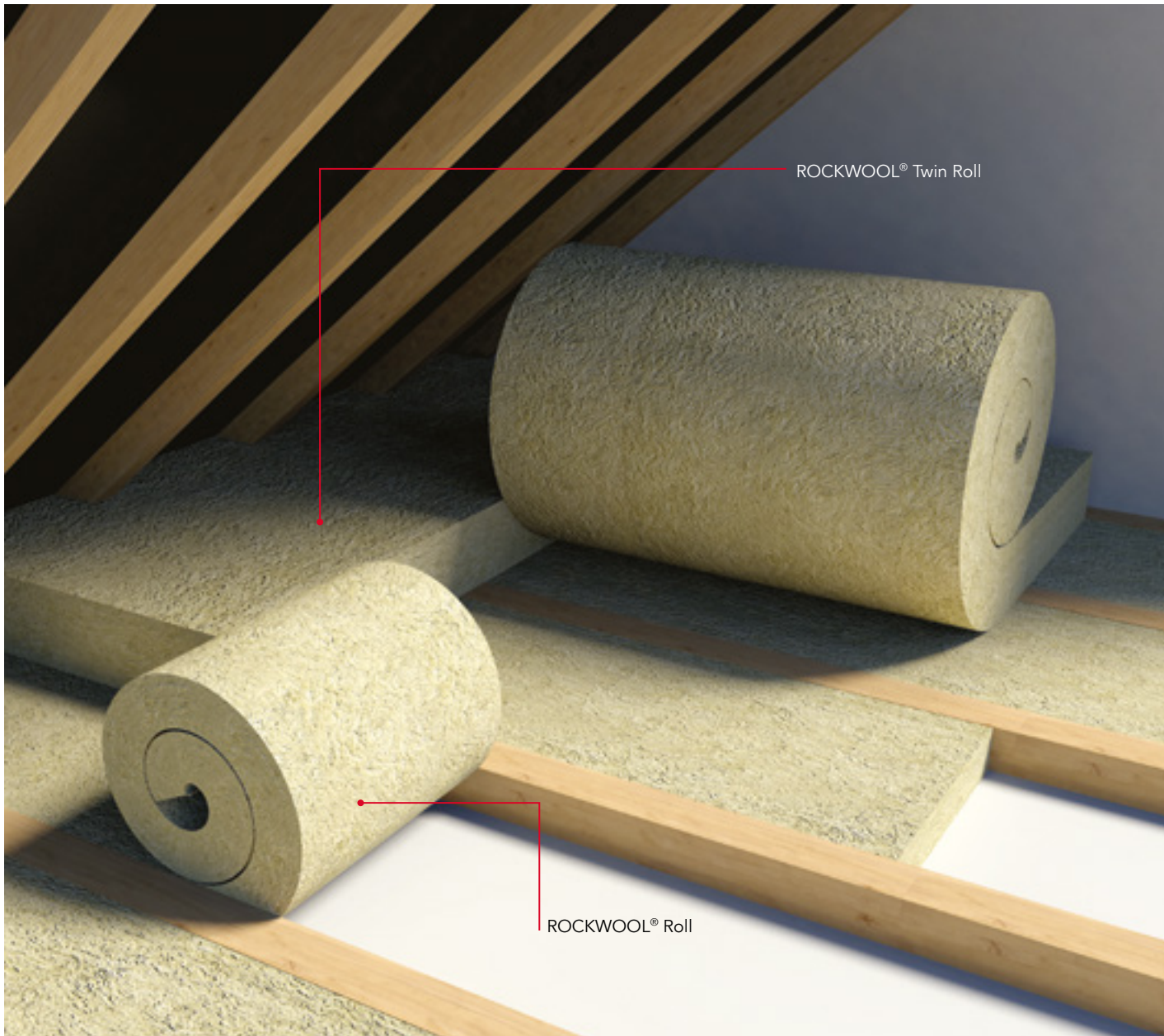

Installing the right insulation can go a long way to keeping homes warm throughout the winter months. According to the Energy Savings Trust, a quarter of heat is lost through the roof of an uninsulated home.

A well-insulated loft space can prevent heat from escaping homes through the roof, resulting in a warmer home. Energy-efficient homes tend to have reduced energy bills and a more comfortable living environment.

When choosing loft insulation, it is important to ensure the right thickness of insulation is installed. The current building guidelines recommend 300mm insulation thickness, but in many homes currently, there is as little as 100mm. This can be particularly true for older houses. Insulation performance plays an important role when choosing the right insulation, factors such as fire resistance and moisture repellence are often overlooked but can make a difference in the lifespan of the insulation material.

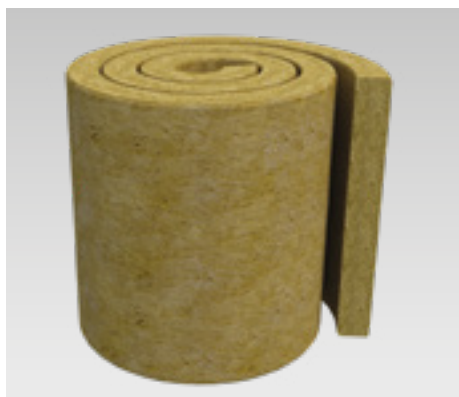

## Roll products

ROCKWOOL Roll, Twin Roll and Rollbatt are medium-density, non-combustible thermal insulation products for roof and loft spaces. They are made from stone wool, have thermal properties, and are sound absorbent.

### Twin Roll

Lambda 0.044 W/mK

Pallet size: 1200mm x 1200mm

Product code	Thickness (mm)	Width (mm)	Length (mm)	Pieces/ Pack	Packs/ Pallet	Area/ Pallet (m <sup>2</sup> )	List price/m <sup>2</sup>
125063	100	1200	2750	2	18	118.80	£14.02

### Roll

Pallet size: 1200mm x 1200mm

Product code	Thickness (mm)	Width (mm)	Length (mm)	Pieces/ Pack	Packs/ Pallet	Area/ Pallet (m <sup>2</sup> )	List price/m <sup>2</sup>
339822	150	1200	3200	1	18	69.12	£22.03

### Rollbatt

Pallet size: 1200mm x 1200mm

Product code	Thickness (mm)	Width (mm)	Length (mm)	Pieces/ Pack	Packs/ Pallet	Area/ Pallet (m <sup>2</sup> )	List price/m <sup>2</sup>
124625	100	400	4800	3	18	103.68	£13.77
124626	100	600	4800	2	18	103.68	£13.77
339692	150	400	3200	3	18	69.12	£21.61
339691	150	600	3200	2	18	69.12	£21.61

# Slab products

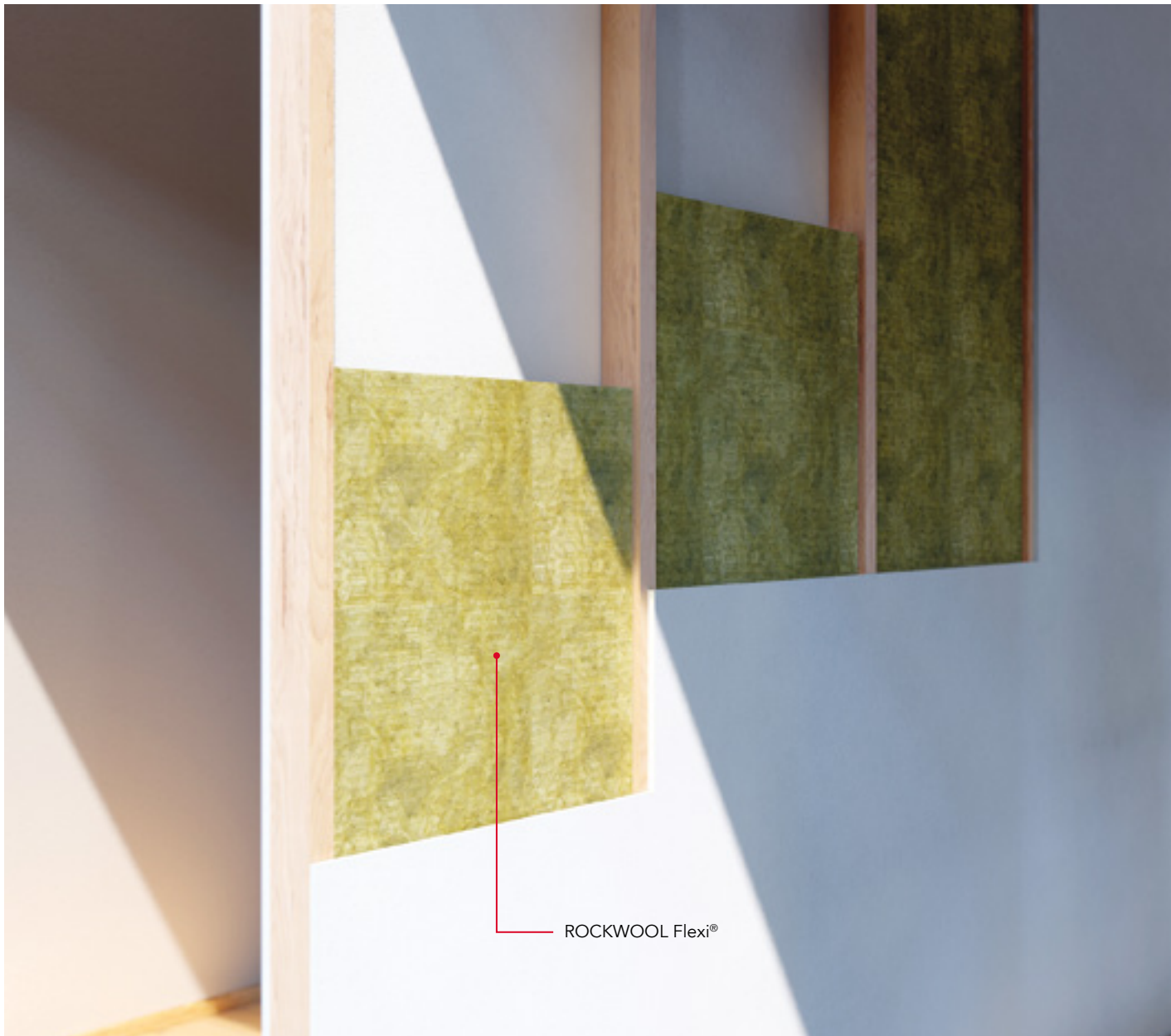

The ROCKWOOL Slab insulation ranges provide thermal, acoustic, and fire resilience (Euroclass A1) for the general building market, in multiple applications including floors, walls, and roofs.

The product ranges consist of resin bonded slabs in a variety of thicknesses and densities.

The ROCKWOOL Slab range is CE marked according to EN 13162:2012 +A1:2015.

*For further information on product performance, please refer to the product datasheets.*

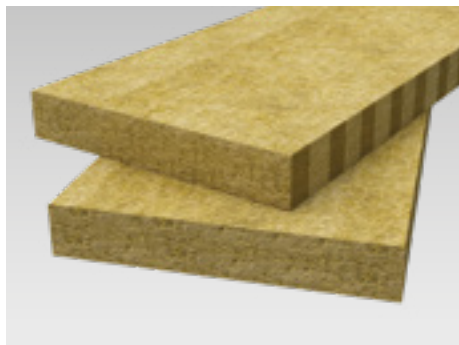

## Flexi®

Flexi® is a multi-use, dual-purpose thermal, and acoustic insulation product with a unique flexible edge along one side.

The flexible edge ensures a fit is maintained between the product and its supporting framework.

Lambda 0.038 W/mK (50mm - 120mm) - 0.035 W/mK (≥140mm)

Pallet size: 1200mm x 1200mm

Product code	Thickness (mm)	Width (mm)	Length (mm)	Pieces/ Pack	Area/ Pack (m <sup>2</sup> )	Packs/ Pallet	Area/ Pallet (m <sup>2</sup> )	Made to Order	MOQ (Pallet)	List price/m <sup>2</sup>
274366	50	400	1200	12	5.76	24	138.24			£9.80
274404	50	600	1200	12	8.64	16	138.24			£9.80
123320	60	600	1200	12	8.64	12	103.68			£11.95
123322	70	600	1200	8	5.76	16	92.16			£15.23
123324	90	600	1200	6	4.32	20	86.40			£17.05
123325	100	400	1200	6	2.88	30	86.40			£19.45
123326	100	600	1200	6	4.32	20	86.40			£19.45
123328	120	600	1200	6	4.32	16	69.12	•	16	£24.25
123329	140	400	1200	4	1.92	24	46.08			£27.20
123330	140	600	1200	4	2.88	16	46.08			£27.20
163833	180	600	1200	3	2.16	12	25.92			£34.93



## RW Slab range

The versatile ROCKWOOL RW Slab range is used for thermal, acoustic, and fire resilience in general building applications.

A range of alternative sizes and facings (tissue and foil) are available on request subject to minimum order quantities.

## RWA45

Lambda 0.035 W/mK

Pallet size: 1200mm x 1200mm

Product code	Thickness (mm)	Width (mm)	Length (mm)	Pieces/ Pack	Area/ Pack (m <sup>2</sup> )	Packs/ Pallet	Area/ Pallet (m <sup>2</sup> )	Made to Order	MOQ (Pallet)	List price/m <sup>2</sup>
181173	25	600	1200	16	11.52	12	138.24			£5.05
181174	30	600	1200	12	8.64	16	138.24			£6.07
181175	40	600	1200	12	8.64	16	138.24			£8.08
181176	50	600	1200	9	6.48	16	103.68			£9.86
181177	60	600	1200	8	5.76	16	92.16			£12.20
209290	75	600	1200	6	4.32	20	86.40			£14.72
209274	100	600	1200	4	2.88	20	57.60			£19.51

## RW3

Lambda 0.034 W/mK

Pallet size: 1200mm x 1200mm

	Product code	Thickness (mm)	Width (mm)	Length (mm)	Pieces/ Pack	Area/ Pack (m <sup>2</sup> )	Packs/ Pallet	Area/ Pallet (m <sup>2</sup> )	Made to Order	MOQ (Pallet)	List price/m <sup>2</sup>
	181180	25	600	1200	16	11.52	12	138.24			£6.73
	181181	30	600	1200	15	10.80	12	129.60			£7.92
	181182	40	600	1200	10	7.20	12	86.40			£10.40
	181183	50	600	1200	8	5.76	12	69.12			£12.59
	181184	60	600	1200	6	4.32	12	51.84			£15.58
	181185	75	600	1200	6	4.32	12	51.84			£18.83
	237922	90	600	1200	5	3.60	12	43.20			£24.32
	181186	100	600	1200	4	2.88	12	34.56			£25.40
*	181188	50	600	1000	8	4.80	15	72.00	•	22	£17.73
□	181189	30	600	1000	10	6.00	20	120.00	•	22	£14.96
■	181244	100	600	1000	4	2.40	15	36.00	•	22	£44.18

**KEY:** \* Black Tissue Faced □ White Tissue Faced ■ Foil Faced

## RW4

Lambda 0.034 W/mK

Pallet size: 2400mm x 1200mm

Product code	Thickness (mm)	Width (mm)	Length (mm)	Pieces/ Pack	Area/ Pack (m <sup>2</sup> )	Packs/ Pallet	Area/ Pallet (m <sup>2</sup> )	Made to Order	MOQ (Pallet)	List price/m <sup>2</sup>
181191	50	600	1200	6	4.32	16	69.12	•	22	£17.08
181192	75	600	1200	4	2.88	16	46.08	•	22	£25.56
181193	100	600	1200	3	2.16	16	34.56			£34.16

## RW5

Lambda 0.034 W/mK

Pallet size: 2400mm x 1200mm

Product code	Thickness (mm)	Width (mm)	Length (mm)	Pieces/ Pack	Area/ Pack (m <sup>2</sup> )	Packs/ Pallet	Area/ Pallet (m <sup>2</sup> )	Made to Order	MOQ (Pallet)	List price/m <sup>2</sup>
181194	25	600	1200	8	5.76	24	138.24			£9.80
181195	30	600	1200	8	5.76	20	115.20			£11.85
181197	50	600	1200	4	2.88	24	69.12			£19.22
181199	75	600	1200	3	2.16	20	43.20			£28.79
181200	100	600	1200	2	1.44	24	34.56			£38.22
181265	*150	600	1200	32	23.04	1	23.04	•	22	£68.24

# Your choice of building materials matters



To find out why,  
scan the QR code:



[rockwool.com/uk](https://rockwool.com/uk)

# Structural and Cavity Fire Protection products



In the event of a fire, our tested fire protection solutions slow the spread of the flames. ROCKWOOL stone wool does not produce any significant toxic smoke and also helps protect the building's load-bearing structure, protecting lives and investment.

By protecting the structural frame of the building from destruction by fire, it is possible to give occupants more time to escape, and to limit damage to the building.

ROCKWOOL stone wool insulation can tolerate temperatures in excess of 1000°C and demonstrates proven fire resilience.

*For further information on product performance, please refer to the product datasheets.*

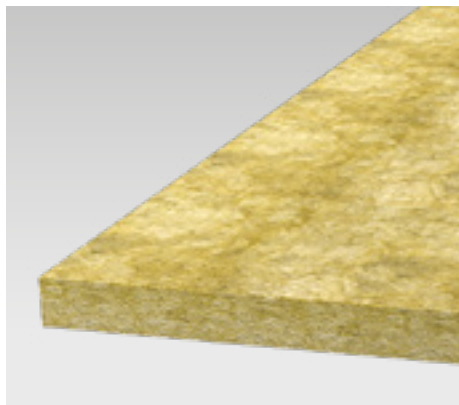

## BeamClad®

ROCKWOOL BeamClad® is a non-combustible stone wool insulation slab, designed and tested to provide up to 4 hours' protection to structural steel.\*

### Benefits:

- Up to 4 hours' fire resistance\*
- Dry-fix or adhered installation
- Moisture repellent
- No maintenance

\*Subject to the application.

## BeamClad®

Pallet size: 2000mm x 1200mm

Product code	Additional information	Thickness (mm)	Width (mm)	Length (mm)	Pieces/Pallet	Area/Pallet (m <sup>2</sup> )	Made to Order	MOQ (Pallet)	List price/m <sup>2</sup>
122706	Plain	25	1200	2000	45	108.00			£27.22
122708	Plain	30	1200	2000	40	96.00	•	8	£40.33
122709	Plain	35	1200	2000	32	76.80	•	8	£49.48
122710	Plain	40	1200	2000	30	72.00			£53.88
122711	Plain	50	1200	2000	24	57.60	•	5	£67.37
122698	Foil Faced	25	1200	2000	45	108.00	•	4	£38.23
122699	Foil Faced	30	1200	2000	40	96.00	•	4	£51.30
122701	Foil Faced	40	1200	2000	30	72.00	•	4	£64.83
254656	Foil Faced	50	1200	2000	24	57.60	•	6	£78.35



## FirePro® Glue

ROCKWOOL FirePro® Glue is a water-based fire resistant adhesive for use within ROCKWOOL fire protection systems and other suitable ROCKWOOL products where a fire resistant adhesive is needed.

### Benefits:

- Listed on the LUL Product Register
- Can use from 10°C upwards
- Cures in as little as 4 hours

Product code	Tub size (kg)	Tubs/Pallet	MOQ (Tub)	List price/Tub
128034	17	48	1	£173.72

Product code	Cartridge size (ml)	Cartridges/Pack	MOQ (Pack)	List price/Pack
276658	300	12	1	£127.51

Approximate coverage 10.2m<sup>2</sup>/tub subject to application thickness.

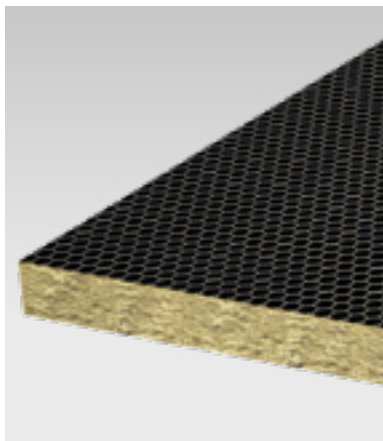

## Fire Barrier EN

ROCKWOOL Fire Barrier EN is a wire-reinforced high-density stone wool roll designed for inhibiting the passage of fire and smoke through extensive cavities within buildings.

The product has been classified to BS EN 13501-2:2016 based on testing to the following standards:

- BS EN 1364-1:2015
- BS EN 1634-1:2014+A1:2018
- BS EN 1366-3:2021

For further details please see the product's UL Classification Reports available on our website.

### Fire Barrier EN

Pallet size: 1200mm x 1200mm

Product code	Foil facing	Thickness (mm)	Width (mm)	Length (mm)	Rolls/ Pack	Area/ Pack (m <sup>2</sup> )	Packs/ Pallet	Area/ Pallet (m <sup>2</sup> )	MOQ (Pallet)	List price/m <sup>2</sup>
351875	1 side	50	1000	3800	1	3.80	21	79.80	1	£32.91
351879	2 sides	50	1000	3800	1	3.80	21	79.80	1	£39.97

### Fire Barrier EN Fixings

Product code	Item	Thickness (mm)	Length (mm)	Pieces/ Pack	MOQ (Pallet)	List price/ Pack
352076	Fire Barrier EN Angle Support	2.0	1000	10	1	£139.84
352074	Fire Barrier EN Clamping Plate	2.0	1000	10	1	£79.79



## SP FireStop EN

SP FireStop EN comprises of a stone wool slab faced with high emissivity black aluminium foil on both sides and is supplied in two thickness options depending on the fire rating required.

SP FireStop EN has been tested in accordance with BS EN 1366-4:2021 and is suitable for use as a linear cavity firestop in both vertical and horizontal orientations.

Benefits:

- Tested against an SFS substrate both horizontally and vertically
- Up to EI 120 in cavities up to 600mm\*
- Resists the passage of smoke - black aluminium foil on both sides

\*Subject to the application.

### SP FireStop EN Slab

Pallet size: 2000mm x 1200mm

Product code	Fire rating (Up to mins)	Thickness (mm)	Width (mm)	Length (mm)	Pieces/ Pallet	Area/ Pallet (m <sup>2</sup> )	MOQ (Pallet)	List price/m <sup>2</sup>
336804	60	75	1000	1200	32	38.40	1	£163.72
333802	120	90	1000	1200	24	28.80	1	£196.96

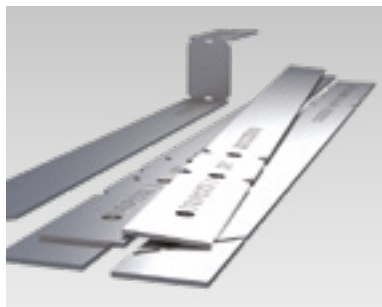

## SP FireStop Fixing Brackets

ROCKWOOL SP Fixing Brackets are supplied in three standard sizes; SP/S (small), SP/L (large), and \*SP/XL for cavity widths up to 600mm. The brackets are supplied in cardboard boxes of 50 pieces, flat-packed and designed to be easily re-profiled by hand on site.

*\*SP/XL brackets are developed for use with SP FireStop Plus Slab® for 2 hours fire resistance in cavities up to 600mm.*

### SP FireStop Fixing Brackets

Product code	Additional information	Cavity size (Up to mm)	Unit	Pieces/ Pack	MOQ (Pack)	List price/ Pack
128709	SP/S (small)	100	Pack	50	1	£68.41
128710	SP/L (large)	400	Pack	50	1	£83.95
259890	SP/XL (extra large)	600	Pack	50	1	£139.49

### SP FireStop Fixing Brackets - Stainless Steel

Product code	Additional information	Cavity size (Up to mm)	Unit	Pieces/ Pack	MOQ (Pack)	List price/ Pack
318285	SP Small SS	100	Pack	50	1	£89.75
318287	SP Large SS	400	Pack	50	1	£174.25
318289	SP Xlarge SS	600	Pack	50	1	£261.15

Carriage charges for SP Firestop Fixing Brackets – Stainless Steel may apply and will be confirmed on receipt of order.

Carriage charges will be waived for Stainless Steel SP Fixing Bracket orders in excess of £1500.

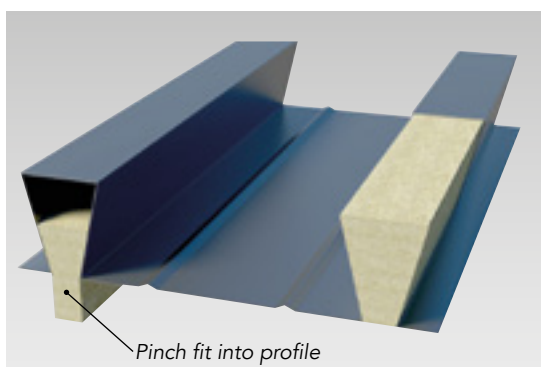

## Dovetail Infills

ROCKWOOL Dovetail Infills are made from medium-density, non-combustible stone wool. Developed to allow compression for 'pinch fit' into the profile, yet it retains the necessary lateral stiffness to aid installation.

Deck profile to be named at time of order.

Length: 300mm

To suit deck manufacturer	To suit profile	Major (mm)	Minor (mm)	Height (mm)	Made to Order	List price/ Each
Kingspan	MD50	40	15	50	•	£3.53
Kingspan	MD60	53	50	9	•	£2.96
Kingspan	MD80	53	50	9	•	£2.96
NSD	MF55	41	17	55	•	£3.53
NSD	MF60	45	45	15	•	£2.96
Richard Lees	Superib	40	15	51	•	£3.53
Richard Lees	ED60	48	42	10	•	£2.96
SMD	R51+	40	13	52	•	£3.53
TATA	CF51+	38	15	51	•	£3.53
TATA	CF60	50	47	15	•	£2.96
TATA	CF80	50	47	15	•	£2.96

Dovetail Infills may incur additional carriage charges, for further information please contact the ROCKWOOL Customer Support Centre.



## Linear FireStop 2A

Linear FireStop 2A provides fire-stopping at the junctions of compartment walls and floors. Tested to BS EN 1366-4:2021 and BS EN 1366-3:2021, they provide up to 4 hours\* fire integrity, fitted as rectangular pieces that tightly butt joint and must be compressed by at least 5% in thickness to ensure a secure fit.

**Benefits:**

- Provides up to 4 hours\* fire integrity
- Available in small quantities

*\*Subject to the application.*

Width (mm)	List price/linear metre by thickness						Length: 1200mm
	15mm Price	25mm Price	30mm Price	40mm Price	50mm Price	60mm Price	Made to Order
75	£2.45	£4.09	£4.46	£5.96	£7.51	£8.96	•
100	£2.89	£4.81	£5.22	£6.90	£8.71	£10.81	•
120	£3.01	£5.10	£5.49	£7.31	£9.22	£11.12	•
140	£3.50	£5.96	£6.42	£8.42	£9.71	£11.63	•
150	£3.60	£6.03	£6.50	£8.47	£10.77	£12.85	•
160	£3.73	£6.24	£6.70	£8.94	£11.30	£13.56	•
170	£3.90	£6.54	£7.06	£9.37	£11.87	£14.20	•
180	£4.08	£6.88	£7.38	£9.85	£12.49	£14.92	•
190	£4.29	£7.24	£7.79	£10.35	£13.14	£15.65	•
200	£4.52	£7.64	£8.26	£10.89	£13.87	£16.58	•

In addition to the sizes shown, ROCKWOOL manufactures a wide range of linear and trapezoidal fire-stop pieces to suit most applications. Linear FireStop 2A may incur additional carriage charges, for further information please contact the ROCKWOOL Customer Support Centre.



## Trapezoidal FireStop 2B

Trapezoidal FireStop 2B helps to prevent the passage of fire and smoke in the deck at the junction of compartment walls and floors. Manufactured slightly oversized to the deck profile to ensure a tight, gap-free fit.

Deck profile to be named at the time of order. Alternatively, if deck brand is unknown, measurements detailed on the left must be provided.

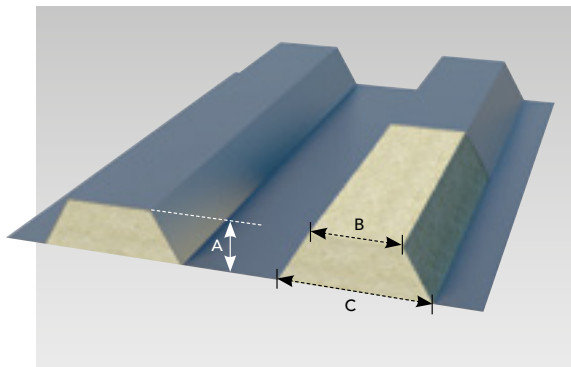

Length: 1200mm

To suit deck manufacturer	To suit profile	Major (mm)	Minor (mm)	Height (mm)	Made to Order	List Price/ Linear m
Kingspan	MD60	213	142	61	•	£13.62
Kingspan	MD80	198	131	80.5	•	£18.83
NSD	MF60	175	130	60	•	£15.49
NSD	MF80	175	130	80	•	£18.83
Richard Lees	Ribdeck S60	180	130.7	60	•	£15.49
Richard Lees	E60	223	153	60	•	£15.49
Richard Lees	RD80	180	115	80	•	£18.83
SMD	TR60+	200	158	60	•	£15.49
SMD	TR80+	178	137	80	•	£18.83
TATA	CF60	180	131	60	•	£15.49
TATA	CF80	180	150	80	•	£18.83
TATA	D35	115	75	35	•	£9.18
TATA	D46	158	105	46	•	£13.47
TATA	D60	136	90	60	•	£13.62
TATA	D100	170.3	109	100	•	£25.51
TATA	D135	267	145	137	•	£38.46
TATA	D153	240	119	153	•	£39.43
TATA	D159	212	108	159	•	£39.43

Linear and Trapezoidal FireStop orders cannot be used to contribute towards mixed loads.

The lead times for these products can vary and will be confirmed on receipt of order.

Trapezoidal FireStop 2B may incur additional carriage charges, for further information please contact the ROCKWOOL Customer Support Centre.

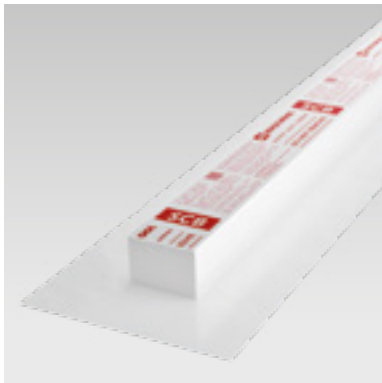

## SCB

ROCKWOOL SCB (Sleeved Cavity Barrier) consists of a stone wool insulation strip encapsulated in a protective polythene sleeve. Fitted under compression, the product acts to inhibit the passage of smoke and fire within masonry, timber and steel frame constructions.

ROCKWOOL SCB has been tested in accordance with BS EN 1364-4:2021 and classified to BS EN 13501-2:2016. For further details please see the product's UL Classification Report available on our website.

Product is supplied in bags packed into cardboard tubes secured on a 1200mm x 1200mm pallet.  
\*Thicknesses marked by an asterisk are supplied in cardboard boxes secured on a 1300mm x 1200mm pallet.  
Available in full pallet quantities only.

Product code	To suit cavity (mm)	Thickness (mm)	Width (mm)	Length (mm)	Pieces/ Bag	Pieces/ Pallet	Linear m/ Bag	Linear m/ Pallet	List price/ Linear m
356250	50-55	65*	110	1200	23	138	27.6	165.6	£6.22
357984	56-65	75	110	1200	20	320	24	384.0	£8.78
365600	66-75	85	110	1200	14	280	16.8	336.0	£8.87
353662	76-90	100	110	1200	15	240	18	288.0	£8.94
356262	91-100	110*	110	1200	14	84	16.8	100.8	£8.99
358129	101-110	120	110	1200	10	200	12	240.0	£12.06
356594	111-120	130	110	1200	12	180	14.4	216.0	£13.29
360197	121-130	140	110	1200	8	160	9.6	192.0	£14.53
355232	131-140	150	110	1200	10	160	12	192.0	£15.74
356263	141-150	160*	110	1200	9	54	10.8	64.8	£16.97
359920	151-160	170	110	1200	5	140	6	168.0	£19.12
356674	161-170	180	110	1200	5	140	6	168.0	£19.27
357891	171-180	190	110	1200	6	120	7.2	144.0	£19.43
362404	181-190	200	110	1200	6	120	7.2	144.0	£19.56
356065	191-200	210	110	1200	6	120	7.2	144.0	£19.72
353836	201-210	220	110	1200	5	100	6	120.0	£20.68
362141	211-220	230	110	1200	5	100	6	120.0	£21.65
359515	221-230	240	110	1200	5	100	6	120.0	£21.77
357218	231-240	250	110	1200	5	100	6	120.0	£21.88
359523	241-250	260	110	1200	5	80	6	96.0	£21.99
376505	251-260	270	110	1200	5	80	6	96.0	£22.11
	261-270	280	110	1200	4	80	4.8	96.0	£22.22
374606	271-280	290	110	1200	4	80	4.8	96.0	£22.33
354607	281-290	300	110	1200	4	80	4.8	96.0	£22.45



## SCB

ROCKWOOL SCB (Sleeved Cavity Barrier) consists of a stone wool insulation strip encapsulated in a protective polythene sleeve. Fitted under compression, the product acts to inhibit the passage of smoke and fire within masonry, timber, and steel frame constructions.

ROCKWOOL SCB has been tested in accordance with BS EN 1364-4:2021 and classified to BS EN 13501-2:2016. For further details please see the product's UL Classification Report available on our website.

Product is supplied in bags packed into cardboard tubes secured on a 1200mm x 1200mm pallet.  
\*Thicknesses marked by an asterisk are supplied in cardboard boxes secured on a 1300mm x 1200mm pallet.  
Available in full pallet quantities only.

Product code	To suit cavity (mm)	Thickness (mm)	Width (mm)	Length (mm)	Pieces/ Bag	Pieces/ Pallet	Linear m/ Bag	Linear m/ Pallet	List price/ Linear m
356264	50-55	65*	200	1200	12	72	14.4	86.4	£11.66
359964	56-65	75	200	1200	10	180	12	216.0	£16.93
369650	66-75	85	200	1200	7	154	8.4	182.4	£17.10
356243	76-90	100	200	1200	6	132	7.2	158.4	£17.28
356265	91-100	110*	200	1200	7	42	8.4	50.4	£17.46
	101-110	120	200	1200	6	108	7.2	129.6	£20.60
356597	111-120	130	200	1200	3	102	3.6	122.4	£20.75
363264	121-130	140	200	1200	6	96	7.2	115.2	£20.91
363819	131-140	150	200	1200	6	90	7.2	108.0	£21.07
356266	141-150	160*	200	1200	5	30	6	36.0	£21.22
362781	151-160	170	200	1200	3	78	3.6	93.6	£27.74
356676	161-170	180	200	1200	4	72	4.8	86.4	£27.92
357969	171-180	190	200	1200	4	72	4.8	86.4	£28.09
372643	181-190	200	200	1200	3	66	3.6	79.2	£28.25
353707	191-200	210	200	1200	3	66	3.6	79.2	£28.43
	201-210	220	200	1200	3	60	3.6	72.0	£28.59
	211-220	230	200	1200	3	60	3.6	72.0	£29.13
	221-230	240	200	1200	3	54	3.6	64.8	£29.36
369889	231-240	250	200	1200	3	54	3.6	64.8	£29.59
	241-250	260	200	1200	3	48	3.6	57.6	£29.82
	251-260	270	200	1200	3	48	3.6	57.6	£30.03
	261-270	280	200	1200	3	48	3.6	57.6	£30.15
377311	271-280	290	200	1200	3	48	3.6	57.6	£30.61
354608	281-290	300	200	1200	2	44	2.4	52.8	£31.07

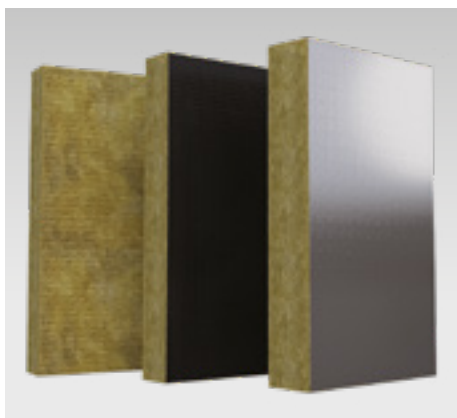

## Soffit Slab

Soffit Slab is a non-combustible stone wool insulation designed for concrete soffits, offering thermal performance and fire resistance.

Benefits:

- Non-combustible
- Water repellent
- Up to 4 hours' fire resistance\*
- High-Impact version features 6mm fibre cement facing board

\*Subject to the application.

## Soffit Slab

Pallet size: 2000mm x 1200mm

Product code	Additional information	Thickness (mm)	Width (mm)	Length (mm)	Pieces/Pallet	Area/Pallet (m <sup>2</sup> )	Made to Order	MOQ (Pallet)	List price/m <sup>2</sup>
272234	Plain	50	600	1000	96	57.6	•	8	£35.19
124809	Plain	130	600	1000	36	21.60			£65.87
124813	Plain	160	600	1000	32	19.20			£81.03
124814	Plain	180	600	1000	24	14.40			£90.20
299730	Plain	200	600	1000	24	14.40	•	10	£98.96
309600	Plain	220	600	1000	16	9.60			£107.74
124802	Foil faced	130	600	1000	36	21.60			£76.85
124804	Foil faced	145	600	1000	32	19.20	•	14	£86.38
124806	Foil faced	160	600	1000	32	19.20	•	14	£94.01
124816	Tissue faced (black)	130	600	1000	36	21.60	•	12	£74.33
239238	Tissue faced (black)	160	600	1000	32	19.20	•	14	£89.46
124822	Tissue faced (white)	130	600	1000	36	21.60	•	12	£74.33

## High-Impact Soffit Slab

Pallet size: 2400mm x 1200mm

Product code	Additional information	Thickness (mm)	Width (mm)	Length (mm)	Pieces/Pallet	Area/Pallet (m <sup>2</sup> )	Made to Order	MOQ (Pallet)	List price/m <sup>2</sup>
255151	6mm High impact facing	136	600	1200	32	23.04	•	1	£128.99
129544	6mm High impact facing	166	600	1200	24	17.28	•	1	£141.55

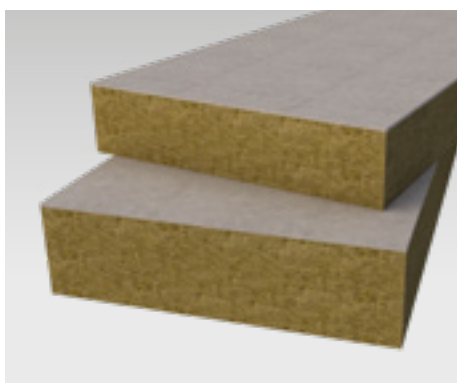

Soffit Slab - High Impact orders cannot be used to contribute towards mixed loads. The lead times for these products can vary and will be confirmed on receipt of order. Contact Customer Services for more information.

# Fire-stopping solutions

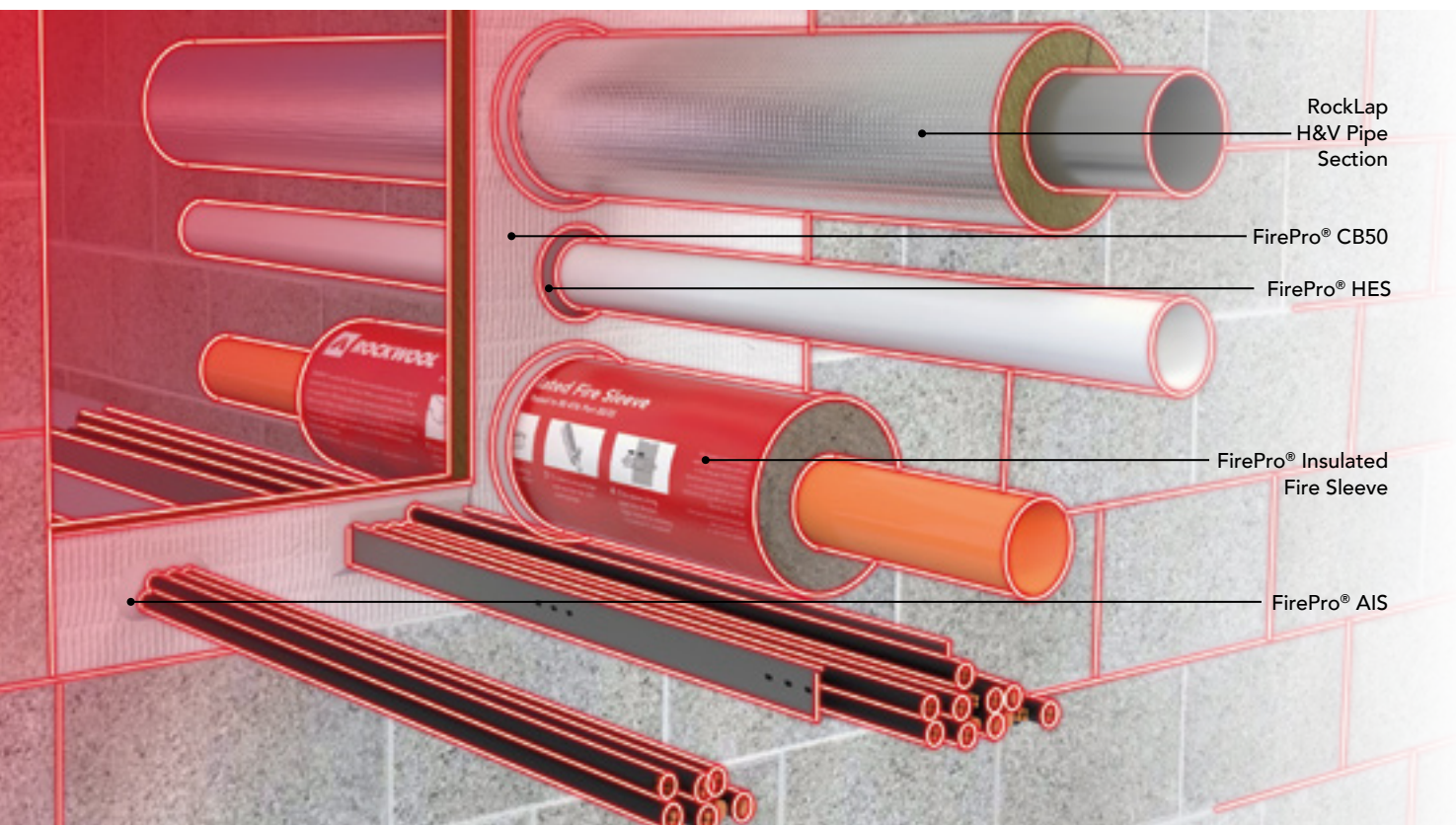

Fire-stopping solutions help to ensure that the fire resistance of compartment walls, floors, and roofs are not compromised by services or voids in the event of a fire.

To stop fire spreading, UK Building Regulations insist on effective compartmentation, where fire, smoke, and gases must be kept for as long as possible where they have originated. Our range of fire-stopping products ensure that cables, pipes, trunking, or ductwork, or the voids that they pass through, don't provide the weak link through which fire can spread.

Our comprehensive range of penetration seals, cavity barriers, cavity fire stops, and linear joint seals are listed in this section and suitable for most applications. However, if your requirement is a little out of the ordinary, contact your local ROCKWOOL representative, you can get their details at: [rockwool.com/uk/contact-us/](http://rockwool.com/uk/contact-us/)

*For further information on product performance, please refer to the product datasheets.*

## NEW RANGE



### FirePro® CB50

Replacing: FirePro® Ablative Coated Batt

FirePro CB50 is an ablative coated batt, consisting of a high-density stone wool core with an outer layer of water based ablative coating.

FirePro CB50 forms part of a fire-stopping solution to seal apertures within a building structure which allow the passage of multiple building services as required.

Designed to reinstate the fire resistance of compartment walls and floors, FirePro CB50 provides fire resistance of up to 120 minutes in accordance with EN 1366-3: 2021+A1:2024, subject to the application.

Pallet size: 1200mm x 1200mm

Product code	Thickness (mm)	Width (mm)	Length (mm)	Pieces/Pallet	Area/Pallet (m <sup>2</sup> )	List price/Batt
368744	50	600	1200	48	34.56	£22.94



### FirePro® CB Coating

Replacing: FirePro® Ablative Liquid

FirePro CB Coating is available in white and supplied in 5L tubs, and is available separately to enable site repairs to FirePro CB50 ablative coated batts that may have been damaged during installation.

Product code	Additional information	Tub size (Litre)	Unit	MOQ (Tub)	List price/Tub
363381	FirePro CB Coating	5	Tub	1	£50.38

For coverage details, please refer to our Technical Datasheet.



### FirePro® AIS

Replacing: FirePro® Acoustic Intumescent Sealant

FirePro AIS can be used as both a fire resistant seal within construction joints and to seal FirePro CB50 within penetration seals.

Designed to reinstate the fire resistance of compartment walls and floors, FirePro AIS provides fire resistance of up to 240 hours in accordance with EN 1366-3: 2021 and EN 1366-4:2021, subject to the application.

Pallet size: 1200mm x 1200mm

Product code	Additional information	Cartridge size (ml)	Tub size (kg)	Unit	Units/Box	Boxes/Pallet	MOQ	Unit list price
363377	Sealant	310		Box	25	64	1 Box	£82.16/Box
363379	Sealant	600		Sausage	12	65	1 Box	£79.63/Box
363378	Trowel Grade		5	Tub		72*	1 Tub	£56.85/Tub

\*The figure quoted is for units/tubs per pallet. For coverage details, please refer to our Technical Datasheet.



## FirePro® Compound

FirePro® Compound is a specially formulated gypsum-based compound, which is mixed with water to be trowelled or poured around service penetrations.

Product code	Bag size (kg)	MOQ (Bag)	List price/ Each
128059	22	1	£62.33

For coverage details, please refer to our Technical Datasheet.



## FirePro® HES

Replacing: FirePro® High Expansion Intumescent Sealant

FirePro HES has been tested as a fire resisting penetration seal, designed to provide high volume expansion and pressure sealing to close off the void left by combustible services after exposure to fire.

FirePro HES provides fire resistance of up to 240 minutes in accordance with EN 1366-3: 2021+A1:2024, for fire-stopping where services penetrate walls and floors, subject to the application.

Product Code	Additional Information	Cartridge Size (ml)	Cartridges/ Pack	MOQ (Pack)	List Price/ Box
363380	Grey	310	25	1	£651.54

For coverage details, please refer to our Technical Datasheet.



## FirePro® PWRoll

Replacing: FirePro® Intumescent Pipe Wrap CE/Pipe Wrap Roll

FirePro PWRoll is an extruded graphite-based intumescent that provides a high volume expansion and pressure seal around services when exposed to fire.

Supplied as a 25m roll to reduce the need to carry a wide range of individually sizes fire-stopping products, the product is 40mm wide, 2mm thick and is suitable for pipes up to 250mm O.D.

FirePro PWRoll provides fire resistance of up to 240 minutes in accordance with EN 1366-3: 2021+A1:2024, for fire-stopping where services penetrate floors, and walls, subject to the application.

Product code	Roll size (m)	Rolls/ Box	MOQ (Box)	List price/ Box
363376	25	1	1	£508.63



For further information on shipping options, please contact our customer support team. Please be advised that orders for these products may incur additional carriage charges.

## NEW RANGE

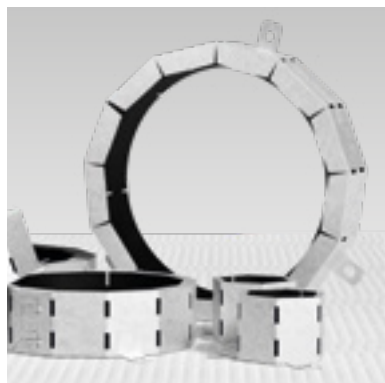

### FirePro® Pipe Collar

Replacing: FirePro® Pipe Collar CE

FirePro Pipe Collar is suitable for use on flexible walls, rigid walls, and rigid floor constructions, and is tested as a penetration seal to reinstate the fire performance of the wall or floor construction.

FirePro Pipe Collar provides fire resistance of up to 240 minutes in accordance with EN 1366-3: 2021+A1:2024, for fire-stopping where services penetrate floors, and up to 120 minutes in flexible and rigid wall constructions, subject to the application.

Product code	Nominal O/D (mm)	MOQ (Each)	List price/ Each
363382	40	1	£23.20
363383	55	1	£27.90
363384	63	1	£29.02
363385	75	1	£40.56
363386	82	1	£41.99
363387	90	1	£49.72
363388	110	1	£58.29
363389	125	1	£77.49
363390	140	1	£125.75
363391	160	1	£137.93



### FirePro® Rapid Seal

FirePro Rapid Seal is a flexible, silicone-based intumescent polymer, engineered to expand and form an insulating char when exposed to fire. Sized as a 60mm or 100mm diameter disc, tested in accordance with BS EN 1366-3: 2021+A1:2024.

Product code	To suit service opening	Diameter (mm)	Pieces/ Pack	MOQ (Box)	List price/ Each
363374	25mm x 25mm	60	20	1	£89.48
363375	50mm x 50mm	100	20	1	£116.12

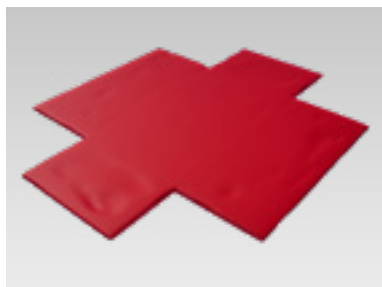

## FirePro® Socket Pad

FirePro Socket Pad is a flexible, silicone-based intumescent polymer, engineered to expand and form an insulating char when exposed to fire, effectively sealing penetrations to prevent the spread of fire and smoke.

Tested in accordance with BS EN 1366-3: 2021+A1:2024.

Pre-cut for installation with single or double socket boxes.

Product code	Additional information	Pad/Box	MOQ (Each)	List price/ Each
363372	Internal Single	20	1	£12.16
363373	Internal Double	20	1	£17.51

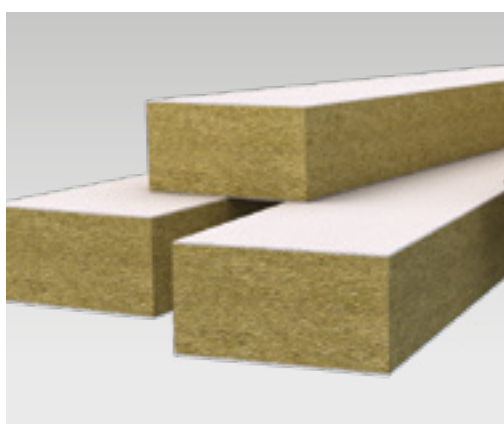

## FirePro® Flex Seal

FirePro Flex Seal Coated Strip is designed for use in penetration seals within fire-rated constructions.

FirePro Flex Seal Coated Strip can be used as a standalone penetration seal or as part of the CB50 coated batt seal.

FirePro Flex Seal Coated Strip has replaced FirePro SoftSeal Coated Strip as the new EN-tested solution.

### FirePro® Flex Seal

Product code	Additional information	Thickness (mm)	Width (mm)	Length (mm)	Pieces/pallet	Area/pallet (m <sup>2</sup> )	Made to Order	MOQ (Pallet)	List Price/each
363369	Coated Strip - Coated 2 sides	100	200	1200	72	17.28	•	1	£43.67

### FirePro® Flex Seal Coating

Product code	Additional information	Unit size	Unit/pack	Made to Order	MOQ	Unit list price
363394	Flex Seal Coating	5ltr	Tub		1 Tub	£151.01/Tub



Scan to  
learn more



[rockwool.com/uk/  
next-gen-firepro](https://rockwool.com/uk/next-gen-firepro)

# Next-generation FirePro®

**Introducing next-generation FirePro®, ROCKWOOL's new range of fire-stopping products.**

Tested and classified to the latest relevant EN fire resistance standards, holding third party certification under the UL-EU Mark, our new FirePro range supports ongoing innovation and the pursuit of industry leading performance and sustainability.

**Make the switch to next-generation FirePro.**

# Download our new Fire-stopping Standard Details Guide



Let us help you to specify our new fire-stopping products with confidence. The Fire-stopping Standard Details Guide gives you in-depth guidance on the performance parameters of our passive fire-stopping products.

These standard details provide the technical information you need to specify FirePro® products, including fire resistance testing, classification, and third-party product certification.

Scan to  
download today:



[rockwool.com/uk/](https://rockwool.com/uk/)

[< Back to Contents page](#)

## EXISTING RANGE



### FirePro® Silicone X

Supplied in 310ml cartridges, FirePro® Silicone X is a fire resistant silicone sealant designed for use as a linear joint seal within construction joints of walls and floors. Silicone X is white in colour and is suitable for construction joints of up to 60mm.

#### Benefits:

- Suitable for internal and external use
- Can provide a cold smoke seal
- Tested with multiple substrates
- Cartridges contain 30% recycled plastic

Product Code	Additional Information	Cartridge Size (ml)	Cartridges/ Pack	MOQ (Pack)	List Price/ Cartridge
322075	White	310	25	1	£20.09

For coverage details, please refer to our Technical Datasheet.



### FirePro® Insulated Fire Sleeves

Insulated Fire Sleeves are made up of a combination of stone wool and graphite intumescent; as a result, they provide both thermal insulation and fire resilience.

When exposed to fire, they expand, sealing gaps between the sleeve and the surrounding construction/pipework.

Length: 300mm

Product code	Nominal O/D (mm)	Thickness (mm)	Made to Order	MOQ (Pieces)	List price/ Each
128109	17	25	•	1	£79.40
128110	21	25	•	1	£82.14
128101	27	25	•	1	£88.33
128102	34	25	•	1	£91.40
128103	42	25	•	1	£97.41
128111	48	25	•	1	£100.68
128112	54	25	•	1	£102.20
128113	60	25	•	1	£103.52
128114	67	25	•	1	£106.60
128115	76	25	•	1	£111.06
128105	80	25	•	1	£114.40
128106	89	25	•	1	£126.42
128116	102	25	•	1	£133.33
128107	108	25	•	1	£137.01
128108	114	25	•	1	£144.76
128117	127	25	•	1	£156.17
128118	140	25	•	1	£163.70
128119	160	25	•	1	£180.59
128120	169	25	•	1	£182.93

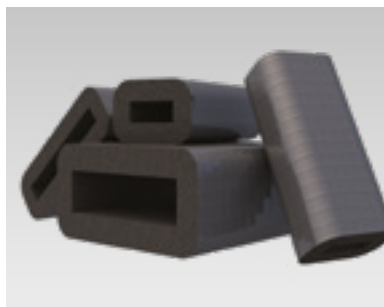

## FirePro® Insulated Fire Duct Sleeve

Insulated Fire Duct Sleeves to be cut to length to suit penetration (minimum length 60mm). Other sizes are available.

Length: 180mm

Product code	Width (mm)	Height (mm)	Made to Order	MOQ (Each)	List price/ Each
223687	110	54	•	1	£77.05
223688	204	60	•	1	£102.65
294019	220	90	•	1	£155.87

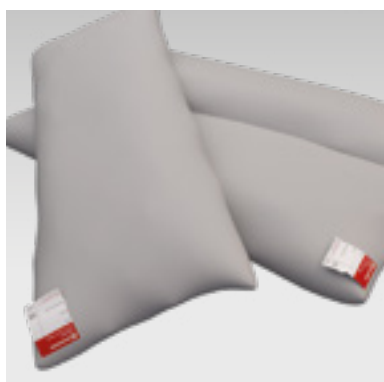

## FirePro® Intumescent Pillow CE

FirePro® Intumescent Pillows CE are available in various sizes for packing into void spaces around services. They are a suitable solution when installing additional services, as they can be removed and reinstated.

Intumescent Pillows CE can be installed within rigid wall and rigid floor constructions. Intumescent Pillows CE are designed to create a temporary or permanent fire seal around services to maintain continuity of fire performance of compartment walls and floors.

Product Code	Thickness (mm)	Width (mm)	Length (mm)	MOQ (Each)	List Price/Each
301310	20	50	330	1	£17.17
301311	25	200	330	1	£23.43
301313	45	200	330	1	£26.80



For further information on shipping options, please contact our customer support team. Please be advised that orders for these products may incur additional carriage charges.

# Building Services and HVAC products



Heating Ventilation and Air Conditioning (HVAC) systems form an integral part of modern environments, both commercial and domestic – particularly where high rise and large scale developments are concerned.

ROCKWOOL non-combustible stone wool products for building services and HVAC applications can be used to help control heat gain, minimise heat loss, and reduce noise. In addition, certain products can deliver a fire resistance rating both into, and out of, the HVAC system.

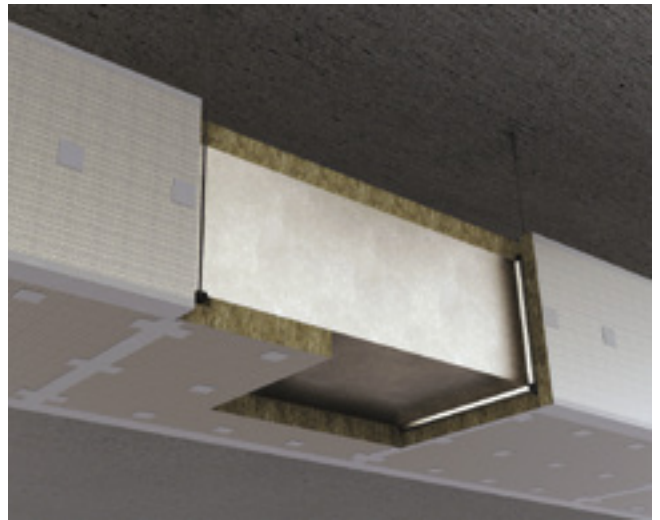

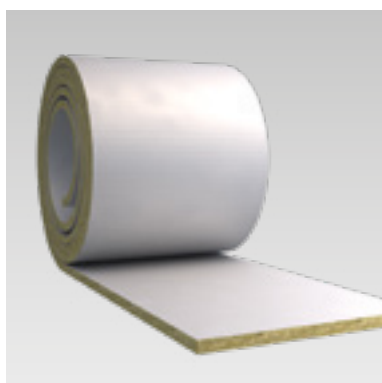

## DuctSlab and DuctWrap

DuctSlab and DuctWrap provide thermal insulation for air conditioning, warm air, and extractor ducts, located either in plant rooms and boiler houses or externally. They can also be used to thermally insulate cold water storage tanks, feeds, and expansion tanks with service temperatures of up to 230°C.

DuctWrap consists of a flexible insulation roll faced with reinforced aluminium foil. DuctSlab consists of a semi-rigid insulation slab faced with reinforced aluminium foil.

### Benefits:

- CE marked to EN 14303:2009+A1:2013
- Non-combustible (Euroclass A1)
- Water repellent
- Chemically inert

*Alternative thicknesses can be made to order.*

*For details please contact your local ROCKWOOL representative.*

Pallet size: 1200mm x 1200mm

Product code	Additional information	Thickness (mm)	Width (mm)	Length (mm)	Pieces/ Pack	Area/ Pack (m <sup>2</sup> )	Packs/ Pallet	Area/ Pallet (m <sup>2</sup> )	List price/m <sup>2</sup>
122929	Slab	40	600	1000	10	6.00	15	90.00	£17.26
122930	Slab	50	600	1000	8	4.80	15	72.00	£20.32
122931	Wrap	25	1000	5000	2	10.00	21	210.00	£13.10
122932	Wrap	40	1000	4000	2	8.00	21	168.00	£16.48
361674	Wrap	50	1000	5000	1	5.00	21	105.00	£19.04

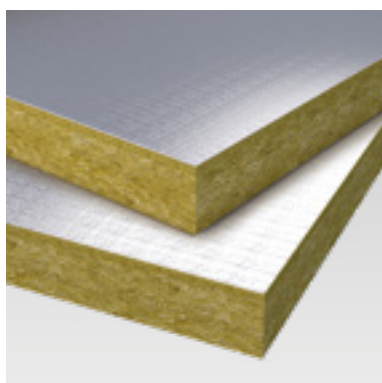

## DuoDuct Slab

DuoDuct is a dual-density stone wool slab with an aluminium foil facing bonded to the outer surface. The outer layer provides impact resistance and a suitable substrate for surface applications such as cladding.

Developed for use on rectangular or square external ductwork, DuoDuct Slab is suitable for insulating cold air, hot air, and dual-purpose duct systems – withstanding service temperatures of up to 230°C.

### Benefits:

- Euroclass A1 non-combustible
- Suitable for use with self-adhered external duct membranes
- ROCKWOOL dual-density technology provides enhanced impact resistance, suitable for areas susceptible to damage
- Sound absorbent qualities to reduce environmental noise

*Alternative thicknesses can be made to order. For details please contact your local ROCKWOOL representative.*

Pallet size: 2000mm x 1200mm

Product code	Additional information	Thickness (mm)	Width (mm)	Length (mm)	Pieces/ Pallet	Area/ Pallet (m <sup>2</sup> )	MOQ (Pallet)	List price/ m <sup>2</sup>
263218	Foil faced	50	1200	2000	24	57.60	1	£22.83

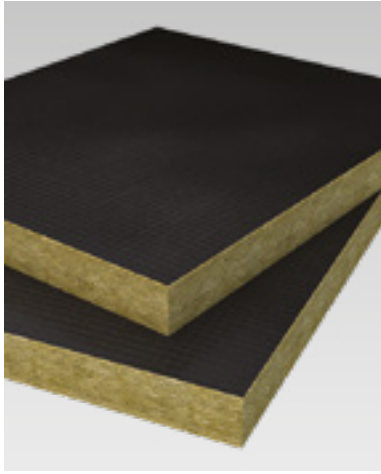

## DuctRock® Slab

Tested to BS EN 1366-1:2014 and BS EN 1366-8:2014, DuctRock® Slab is capable of providing up to 2 hours\* fire rating on both ventilation and smoke extract ducts. The new high emissivity black foil clearly identifies the product as the latest EN tested solution. DuctRock® Slab can achieve fire ratings ranging from EI30 to EI120 with only 3 thicknesses.

### Benefits:

- Up to 2 hours\* fire rating
- Black foil finish
- Suitable with many duct types
- Patented dry wall penetration detail

\*Subject to the application.

Pallet size: 2000mm x 1200mm

Product code	Additional information	Thickness (mm)	Width (mm)	Length (mm)	Pieces/Pallet	Area/Pallet (m <sup>2</sup> )	Made to Order	MOQ (Pallet)	List price/m <sup>2</sup>
262503	Black foil facing	60	1000	1200	42	50.40			£127.31
262505	Black foil facing	80	1000	1200	32	38.40	•	8	£211.01
262507	Black foil facing	90	1000	1200	24	28.80			£237.51

Product code	Additional information	Thickness (mm)	Width (mm)	Length (m)	Rolls/Box	MOQ (Box)	List price/Roll
259345	Black ALU foil tape	N/A	75	50	16	1	£49.73

Product code	Additional information	Thickness (mm)	Width (mm)	Length (mm)	Pieces/Pack	MOQ (Pack)	List price/Pack
273113	Steel U-Profile	1.5	60	1500	4	1	£97.30

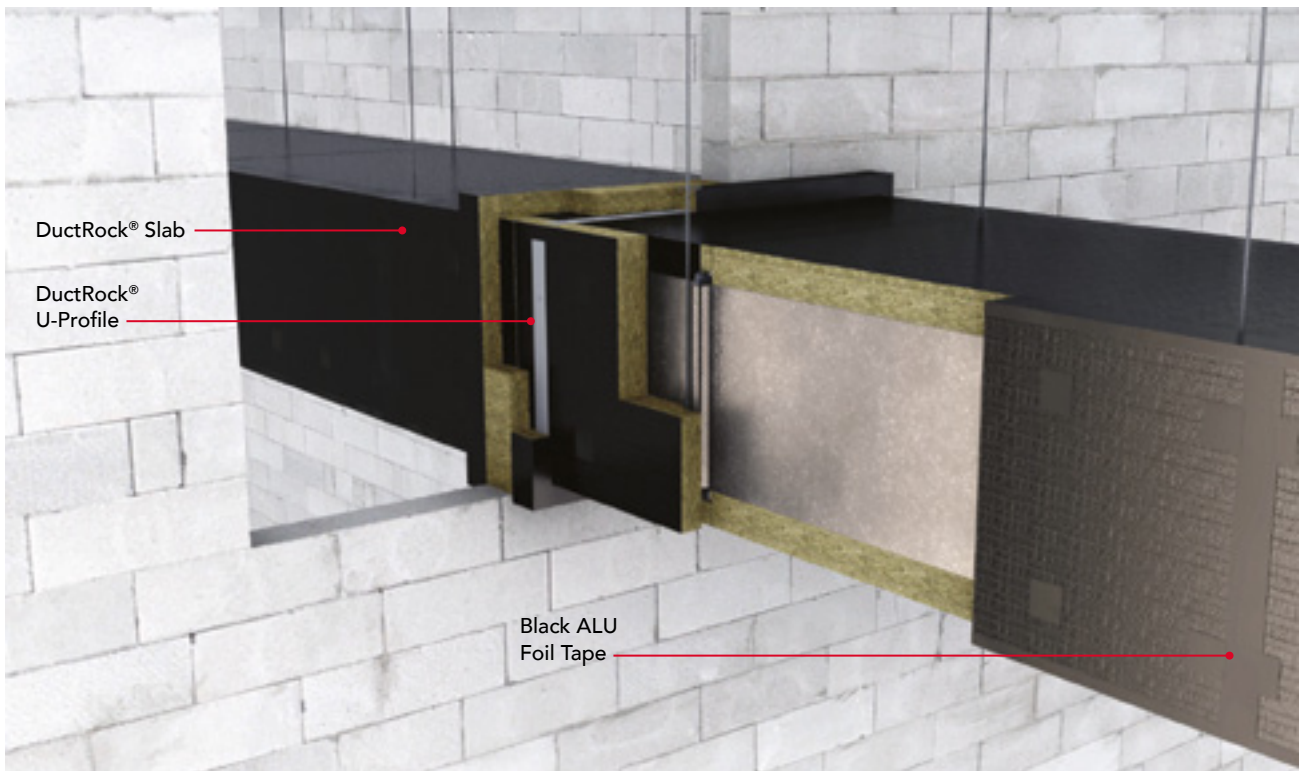

# Achieve CO<sup>2</sup> savings with BS 5422:2023

The Guide to BS 5422:2023 clarifies changes to the technical document for thermal insulation of building services.

Download the comprehensive ROCKWOOL handbook to BS 5422:2023 featuring:

- An accessible changelog
- Updated thickness tables per application
- Insulation best practice
- Recommended ROCKWOOL solutions

**Start specifying today and ensure best practice for building services insulation.**



Download the guide:



[rockwool.com/uk/  
building-services-hvac-hub](https://rockwool.com/uk/building-services-hvac-hub)



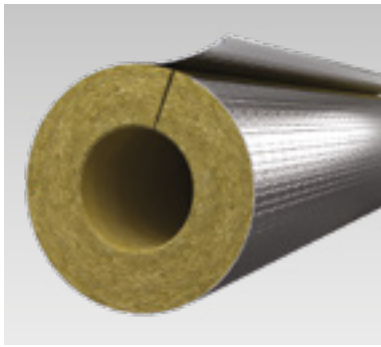

## RockLap H&V Pipe Sections

RockLap H&V Pipe Sections are lengths of pre-formed insulation with a one piece, factory applied foil facing with integral self-adhesive lap.

Please contact ROCKWOOL Customer Support Centre for further information. Alternatives Sizes may be available. For further details please contact your ROCKWOOL Sales Representative. These products are POA, subject to availability and MOQ at the time of enquiry.

To suit pipe O/D per mm	List price/linear metre by thickness														
	20mm			25mm			30mm			40mm			50mm		
	Product code	List price		Product code	List price		Product code	List price		Product code	List price		Product code	List price	
17	379322	£7.51	42	379611	£8.47	30	379632	£11.13	25	*217593	£13.90	12			
21	379351	£7.87	36	379610	£8.79	25	381174	£11.54	20	295306	£14.30	13	362031	£21.29	
27	379613	£8.35	30	379619	£9.61	25	379622	£12.43	20	295307	£14.83	12	361452	£21.58	
34	379623	£9.07	25	379620	£10.45	20	379631	£13.00	16	292268	£16.20	9	292269	£22.91	
42	252816	£10.20	20	378278	£11.54	16	253324	£14.27	12	295310	£17.18	9	295312	£23.98	
48	253613	£10.72	16	253614	£12.43	15	253616	£14.76	12	295297	£18.14	9	295305	£25.15	
54	253618	£11.54	16	378281	£13.40	12	253622	£16.20	10	295298	£19.69	8	295303	£26.97	
60	253624	£12.20	12	253625	£14.27	11	253627	£17.13	9	295299	£20.95	6	295301	£28.49	
67				362314	£18.88	9	362316	£19.69	9	362196	£22.77	6	362197	£30.28	
76				361190	£19.22	9	361192	£20.32	7	361193	£23.44	5	361194	£30.73	
89				361195	£20.46	6	361289	£21.96	6	361197	£25.30	4	361400	£33.36	
102										361647	£31.10				
108				361201	£22.53	4	361202	£26.70	4	361649	£31.80		361650	£41.96	
114				361203	£23.31	4	361198	£28.09	4	361404	£33.27		361405	£43.43	
127				361200	£32.75	4	362038	£32.49		362010	£41.37		362011	£42.83	
133							361524	£32.80					361526	£50.55	
140				362167	£27.17		361411	£31.66		361431	£37.38		361413	£48.04	
154													362372	£112.90	
159				362193	£39.73		361782	£35.21		361786	£38.53		361787	£53.78	
169				362355	£32.46		361517	£37.38		361516	£44.37		361414	£56.58	
194													362172	£61.37	
205										362176	£57.46		362177	£69.11	
219				362179	£42.43		362180	£48.35		362049	£55.86		361415	£71.19	
253										362357	£124.20		362358	£131.58	
273				362361	£117.94		362362	£102.14		362024	£108.28		362025	£99.55	
305										362365	£135.55				
324							362366	£131.06		362368	£137.20		362369	£110.30	
356							362370	£132.97		362371	£143.77				

Benefits:

- Tape requirement reduced
- CE marked to EN 14303:2009+A1:2013

**KEY:** 42 Number of linear metres per carton.  
■ Unsplit sections packed as single lengths and shrink wrapped in polyethylene.  
■ Split sections packed as single lengths and shrink wrapped in polyethylene.  
■ Stocked item.  
  Item is made to order (please allow a minimum of 3 weeks for delivery).  
 \* This size is only available with ROCKWOOL branded foil.

Length: 1000mm

List price/linear metre by thickness														
60mm			70mm			80mm			90mm			100mm		
Product code	List price		Product code	List price		Product Code	List price		Product code	List price		Product code	List price	
362111	£39.37	<span style="background-color: #4CAF50; color: white; padding: 2px;">4</span>												
362112	£41.31	<span style="background-color: #4CAF50; color: white; padding: 2px;">4</span>	362114	£41.50	<span style="color: black;">■</span>									
362113	£42.16	<span style="background-color: #4CAF50; color: white; padding: 2px;">4</span>	362115	£43.40	<span style="color: black;">■</span>									
361187	£43.42	<span style="background-color: #4CAF50; color: white; padding: 2px;">4</span>	362116	£46.04	<span style="color: black;">■</span>	362142	£52.59	<span style="color: black;">■</span>						
362198	£44.97	<span style="color: black;">■</span>	362199	£49.39	<span style="color: black;">■</span>									
361268	£46.92	<span style="color: black;">■</span>	361397	£50.54	<span style="color: black;">■</span>	361398	£56.90	<span style="color: black;">■</span>				362118	£71.57	
361401	£50.12	<span style="color: black;">■</span>	362194	£53.19	<span style="color: black;">■</span>	361402	£60.81	<span style="color: black;">■</span>	362195	£89.91	<span style="color: black;">■</span>	361403	£85.88	
			362160	£64.86	<span style="color: black;">■</span>									
361408	£59.68	<span style="color: black;">■</span>	362164	£66.20	<span style="color: black;">■</span>	361409	£75.64	<span style="color: black;">■</span>	362166	£139.10	<span style="color: black;">■</span>	361410	£100.99	
361790	£66.69	<span style="color: black;">■</span>	362168	£72.41	<span style="color: black;">■</span>	361791	£83.91	<span style="color: black;">■</span>	362170	£164.72	<span style="color: black;">■</span>	361792	£142.69	
361789	£66.31	<span style="color: black;">■</span>												
361651	£73.25	<span style="color: black;">■</span>	362356	£79.74	<span style="color: black;">■</span>	361643	£101.79	<span style="color: black;">■</span>	362354	£220.40	<span style="color: black;">■</span>	361645	£138.15	
362178	£128.80	<span style="color: black;">■</span>												
361451	£110.60	<span style="color: black;">■</span>	362181	£116.46	<span style="color: black;">■</span>	362035	£123.01	<span style="color: black;">■</span>	362182	£292.69	<span style="color: black;">■</span>	362050	£151.19	
362360	£137.31	<span style="color: black;">■</span>												
362027	£104.18	<span style="color: black;">■</span>	362364	£112.91	<span style="color: black;">■</span>	362028	£137.44	<span style="color: black;">■</span>				362029	£167.76	
361449	£124.19	<span style="color: black;">■</span>												

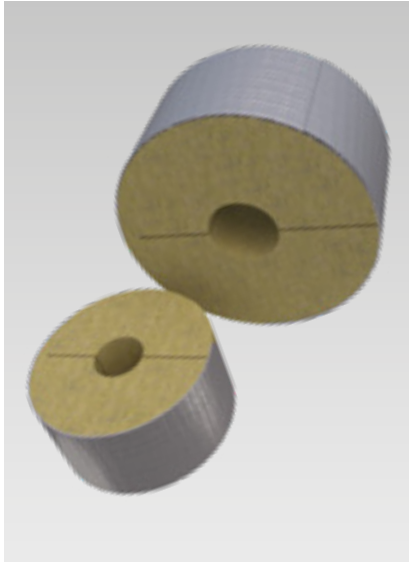

## RockLap H&V Pipe Supports

RockLap Pipe Supports have been developed to reduce the thermal bridge at the point at which the pipe hanger clips are located. Pre-formed and pre-cut into cylindrical sections, with a foil facing finish to maintain an integral vapour barrier. Combined with RockLap H&V Pipe Section insulation solutions, they provide a non-combustible, thermal solution for pipework.

Please contact ROCKWOOL Customer Support Centre for further information. Alternative sizes may be available. For further details please contact your ROCKWOOL Sales Representative.

### ALL PRODUCTS LISTED ARE MADE TO ORDER.

Delivery terms are dependent upon order size:

- ≥40 cartons: Fixed delivery date, no surcharge.
- 15-39 cartons: £70 small order surcharge, fixed delivery date.
- Orders <15 cartons: £70 small order surcharge and subject to groupage within a 5 working day range (Mon - Fri).

To suit pipe O/D (mm)	Length (mm)	20mm			25mm			30mm		
		Product code	Supports/Box	List price/Box	Product code	Supports/Box	List price/Box	Product code	Supports/Box	List price/Box
17	80	287429	128	£654.98	287437	98	£535.49	290202	72	£421.06
21	80	287431	128	£676.05	287434	72	£405.28	290274	72	£436.85
27	80	287436	98	£535.49	287438	72	£409.23	287442	50	£314.33
34	80	287443	72	£443.42	287440	50	£328.96	290200	50	£352.70
42	80	294323	72	£473.69	287444	50	£352.70	290523	32	£289.49
48	80	306127	50	£330.78	290204	50	£491.60	298804	32	£316.95
54	80	298840	50	£333.53	290205	32	£316.95	290584	32	£332.74
60	80	306323	50	£359.10	290209	32	£326.87	294324	32	£354.39
67	80				290214	32	£335.09	301328	18	£230.58
76	80				290210	18	£195.74	299639	18	£237.50
89	80				290216	18	£239.80	300027	18	£284.24
108	80				290217	18	£321.71	293380	8	£163.46
114	80				290218	18	£351.65	300197	8	£175.74
140	80				TBC	8	£179.23	309994	8	£231.14
169	100				312499	8	£253.94	300024	8	£312.43

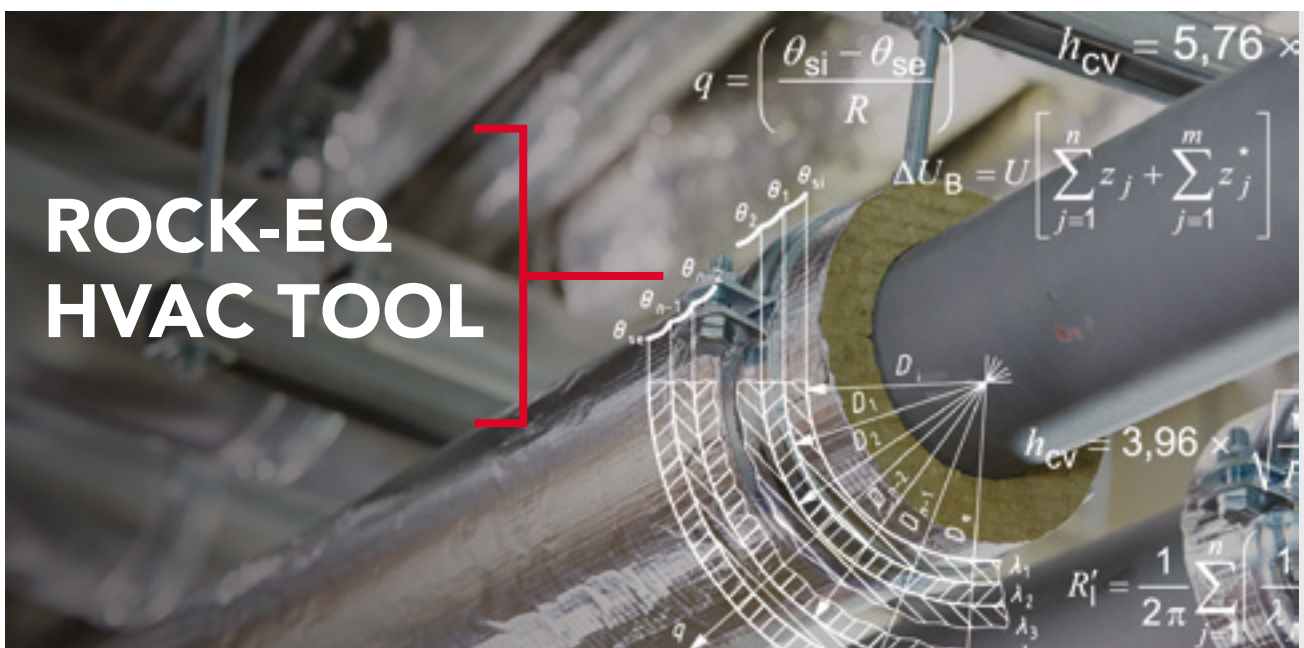

Benefits:

- Euroclass A2<sup>l</sup>-s1, d0
- CE marked in accordance with EN 14303:2009+A1:2013
- High point load resistance and load bearing capability
- A total insulation solution when combined with RockLap H&V Pipe Sections



Orders for RockLap H&V Pipe Supports cannot be used to contribute towards mixed loads. The lead times for these products can vary and will be confirmed on receipt of order.

Pallet size: 1200mm x 1000mm. MOQ (Box): 1

	To suit pipe O/D (mm)	Length (mm)	35mm			40mm			50mm		
			Product code	Supports/Box	List price/Box	Product code	Supports/Box	List price/Box	Product code	Supports/Box	List price/Box
	17	80	315475	50	£356.82	295606	50	£406.62	299927	32	£349.11
	21	80	312932	50	£423.81	287795	32	£267.26	299928	32	£358.49
	27	80	309866	50	£437.73	287794	32	£274.25	299929	18	£205.60
	34	80	300833	32	£328.04	287409	32	£307.60	300174	18	£227.63
	42	80	302746	32	£360.35	287412	32	£358.49	289092	18	£264.82
	48	80	309870	32	£369.81	287414	18	£195.74	TBC	18	£253.29
	54	80	312933	32	£365.35	290525	18	£203.30	294561	18	£260.85
	60	80	309871	18	£219.92	287417	18	£216.43	298725	18	£277.31
	67	80	TBC	18	£262.52	290527	18	£273.34	290526	8	£155.85
	76	80	312934	18	£271.95	287426	18	£279.59	TBC	8	£164.18
	89	80	TBC	18	£296.67	287428	12	£220.34	290585	8	£182.90
	108	80	TBC	10	£208.86	305637	8	£183.20	304193	8	£226.75
	114	80	TBC	10	£221.92	287791	8	£194.73	301329	8	£240.78
	140	80	TBC	10	£290.84	287789	8	£256.02	309993	8	£311.41
	169	100	TBC	8	£311.99	304418	8	£346.91	329593	4	£207.98

Select the optimum thickness of building services and HVAC insulation quickly and easily with our online calculator, ROCK-EQ.

The online tool produces detailed, project-specific calculation reports and recommendations from the ROCKWOOL HVAC range in a matter of minutes.

Find it at:

[rockwool.com/uk/resources-and-tools/tools/](http://rockwool.com/uk/resources-and-tools/tools/)

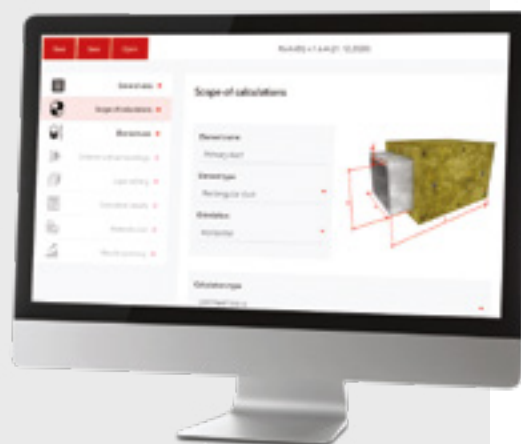

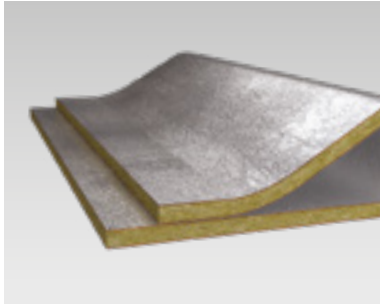

## Techwrap

Made of ROCKWOOL stone wool insulation, an acoustic membrane, and a layer of reinforced aluminium foil, Techwrap is designed to enhance noise control to rectangular ductwork.

5kg/m<sup>2</sup> Polymeric. Pallet size: 1200mm x 1000mm

Product code	Additional information	Thickness (mm)	Width (mm)	Length (mm)	Pieces/Pallet	Made to Order	MOQ (Pallet)	List price/m <sup>2</sup>
251264	Foil faced	25	1000	1200	40	•	1	£143.72
251431	Foil faced	50	1000	1200	20	•	1	£165.21

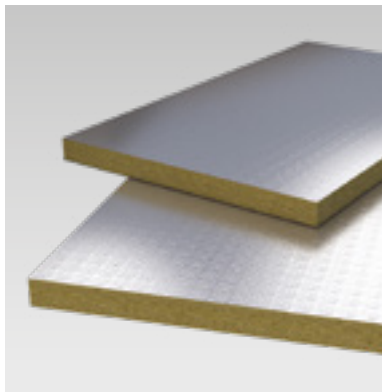

## Fire Duct System

Fire Duct System is developed for use within a square or rectangular third-party tested fire-rated ductwork system.

Please contact a third-party system holder for performance, certification, and installation details.

Pallet size: 2000mm x 1200mm

Product code	Thickness (mm)	Width (mm)	Length (mm)	Pieces/Pallet	Area/Pallet (m <sup>2</sup> )	Made to Order	MOQ (Pallet)	List price/m <sup>2</sup>
364295	40	1200	2000	30	72.00			£99.50
364298	50	1200	2000	24	57.60	•	6	£115.16
364305	90	1200	2000	12	28.80			£214.12



Alternative sizes can be made to order. For details please contact ROCKWOOL Customer Support Centre.  
Techwrap orders cannot be used to contribute towards mixed loads.  
The lead times for these products can vary and will be confirmed on receipt of order.  
Additional carriage charges may apply, please contact Customer Services for information.

**LEGAL NOTICES****General safety requirements – Building Safety Act 2022**

ROCKWOOL Limited is committed to supporting specifiers, resellers and users of ROCKWOOL products for the full life cycle of the product to comply with the obligations and responsibilities set out in the Building Safety Act 2022. With regard to the general safety requirements of the Act, ROCKWOOL Limited cannot control or foresee every situation where its products might be used. We therefore strongly advise that specifiers, resellers and users contact us where use of ROCKWOOL products is contemplated in applications different from those explicitly described in the latest, relevant ROCKWOOL product datasheets; especially in applications that can be reasonably foreseen as critical to safety.

ROCKWOOL Limited reserves the right to amend the specification of its products without notice. Changes to the ROCKWOOL manufacturing process, or to pertinent regulations, may be reflected in changes to tested and certified product performance. Whilst ROCKWOOL Limited endeavours to keep its publications up to date, readers will appreciate that between publications there may be pertinent changes in the law or other developments affecting the accuracy of the information contained in our publications.

ROCKWOOL Limited does not accept responsibility for the consequences of using (including testing or certifying) its products in applications different from those explicitly described in the relevant ROCKWOOL product datasheets. Expert advice should be sought, and ROCKWOOL Limited should be contacted, where such different use is contemplated, or where the extent of any use described by ROCKWOOL Limited is in doubt.

**The ROCKWOOL Trademark**

ROCKWOOL® – our trademark

The ROCKWOOL trademark was initially registered in Denmark as a logo mark back in 1936. In 1937, it was accompanied with a word mark registration; a registration which is now extended to more than 60 countries around the world.

The ROCKWOOL trademark is one of the most important assets of the ROCKWOOL Group, and is therefore well-protected and defended by ROCKWOOL throughout the world.

If you require permission to use the ROCKWOOL logo for your business, advertising or promotion, you must apply for a Trade Mark Usage Agreement.

To apply, write to:  
[marketcom@rockwool.com](mailto:marketcom@rockwool.com)

**Trademarks**

Registered trademarks of the ROCKWOOL Group include but are not limited to:

ROCKWOOL®, RockClose®, RainScreen Duo Slab®, HardRock®, RockFloor® Flexi®, RockFall®, FirePro®, DuctRock®, BeamClad®, NyRock®

© ROCKWOOL 2026.  
All rights reserved.

**Photography and illustrations**

The product illustrations are the property of ROCKWOOL Limited and have been created for indicative purposes only.

Unless indicated below, the photography and illustrations used in this guide are the property of ROCKWOOL Limited. We reserve all rights to the usage of these images.

If you require permission to use ROCKWOOL images, you must apply for a Usage Agreement.

To apply, write to:  
[marketcom@rockwool.com](mailto:marketcom@rockwool.com)

**HEALTH & SAFETY**

A Material Safety Data Sheet is available and can be downloaded from [rockwool.com/uk](http://rockwool.com/uk) to assist in the preparation of risk assessments, as required by the Control of Substances Hazardous to Health Regulations (COSHH).

Company:	ROCKWOOL Limited
Version:	Version 11.00 July 2026 <i>(to check this is the latest version, please refer to <a href="http://rockwool.com/uk">rockwool.com/uk</a>)</i>
Revised on:	20.05.2026
Replaces version:	Version 10.05 March 2026
Changes made:	<ul style="list-style-type: none"><li>• Updated prices</li><li>• Updated testing and certifications</li></ul>
Additional information:	N/A

*Please ensure you are using the latest version of this document by verifying it on our official website. Do not rely on printed or previously downloaded copies, as these may be out of date.*

*Please contact the ROCKWOOL Technical Support Team if you would like to access archived versions of this document.*



July 2026

ROCKWOOL Limited

Pencoed  
Bridgend  
CF35 6NY

Tel: 01656 862 621

[customersupportcentre@rockwool.com](mailto:customersupportcentre@rockwool.com)

[rockwool.com/uk](http://rockwool.com/uk)



Version 11.00 July 2026.  
© ROCKWOOL 2026. All rights reserved.